

2017

C h i b a U n i v e r s i t y  
L a n d s c a p e A r c h i t e c t u r e  
S t u d i o A r c h i v e  
m O e

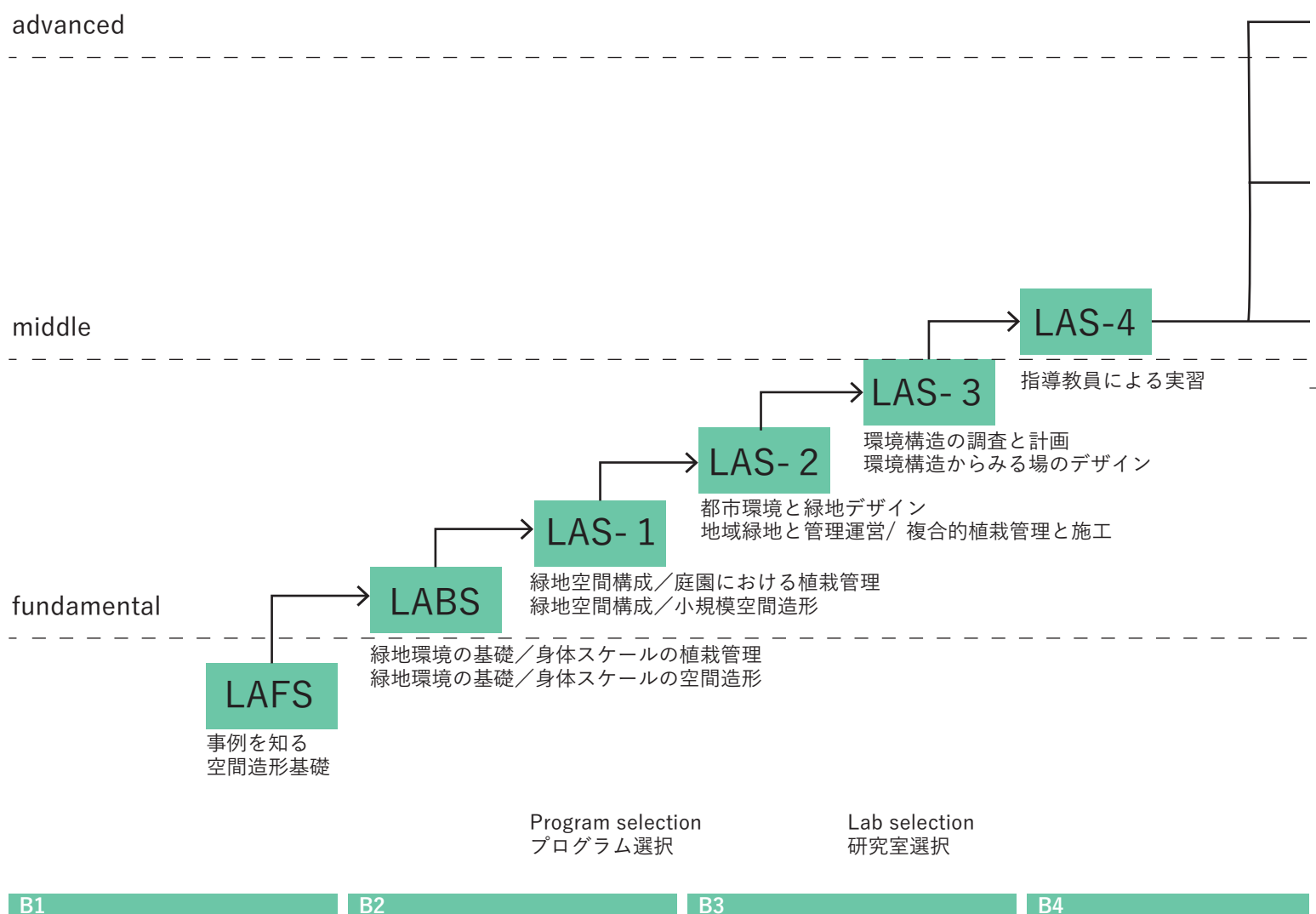

# Structure of Landscape Architecture Studio



## Bachelor

- LAFS : Landscape Architecture Fundamental Studio 緑地環境学基礎実習
- LABS : Landscape Architecture Basic Studio 緑地環境学実習
- LAS 1-4 : Landscape Architecture Studio 1-4 環境造園実習1~4
- LAPS A-E: Landscape Architecture Project Studio A-E 環境造園プロジェクト演習A~E

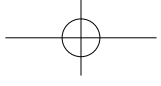

CHIBA UNIVERSITY

Graduate School and Faculty of Horticulture

Field of Landscape Architecture

# Landscape Architecture Studio Archive

## moe

### Bachelor's Studio

- 01 緑地環境学基礎実習 (LAFS) 木下剛
- 02 緑地環境学実習・前 (LABS) 近江
- 03 緑地環境学実習・後 (LABS) 天野 / 木下剛
- 04 環境造園実習 1・前 (LAS-1) 近江
- 05 環境造園実習 1・後 (LAS-1) 近藤 / 齊藤
- 06 環境造園実習 2 - 1 (LAS-2) 石井 / 三谷
- 07 環境造園実習 2 - 1 (LAS-2) 柳井 / 秋田
- 08 環境造園実習 2 - 2 (LAS-2) 坂巻 / 霜田
- 09 環境造園実習 2 - 2 (LAS-2) 近江
- 10 環境造園実習 3 - 1 (LAS-3) 三浦 / 池邊
- 11 環境造園実習 3 - 1 (LAS-3) 向山 / 古谷
- 12 環境造園実習 3 - 2 (LAS-3) 三島 / 木下勇
- 13 環境造園実習 3 - 2 (LAS-3) 鈴木 / 章

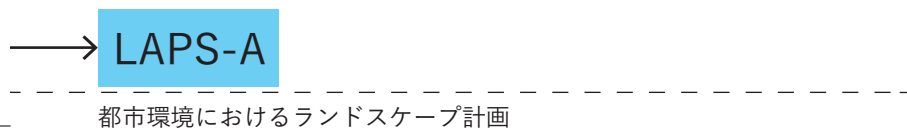
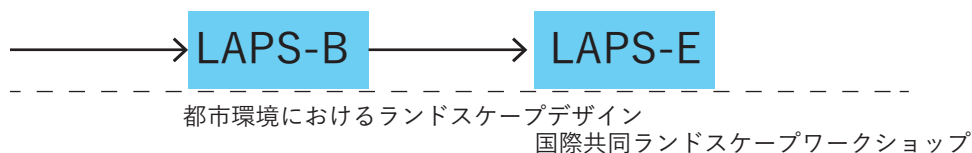

Bachelor's research/design work  
専攻研究 / 制作

Master's research/design work  
修士研究 / 制作

M1

M2

## Master

### Master's Studio

- 01 STUDIO-A Akita, T.Kinoshita, Shimoda
- 02 STUDIO-B T.Kinoshita, Akita, Shimoda
- 03 STUDIO-C I.Kinoshita, Shimoda
- 04 STUDIO-D Shimoda, I.Kinoshita
- 05 STUDIO-E CAPE Landscape Design

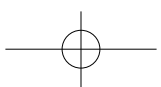

# 修士設計作品

Bachelor's

Master's

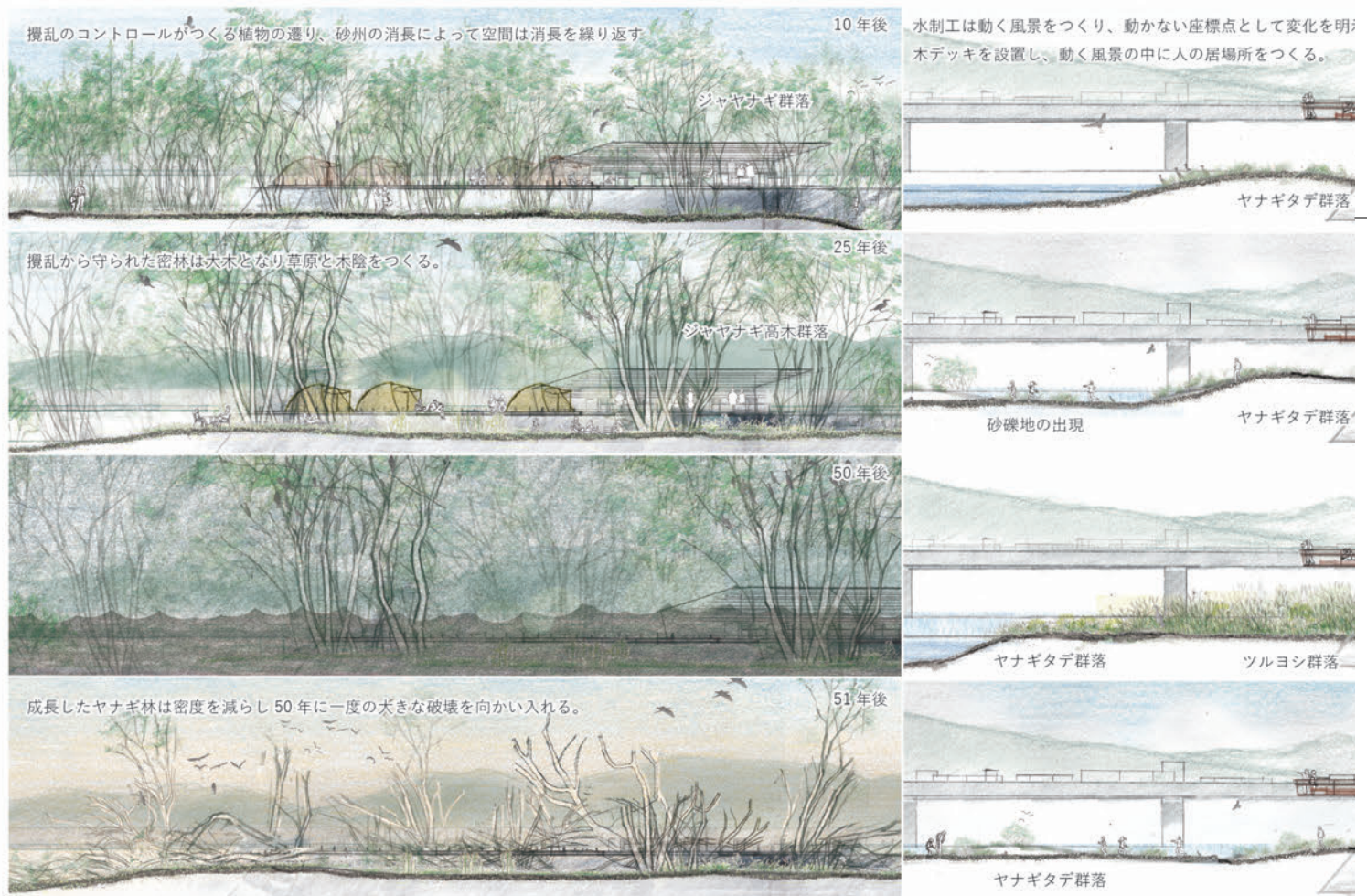
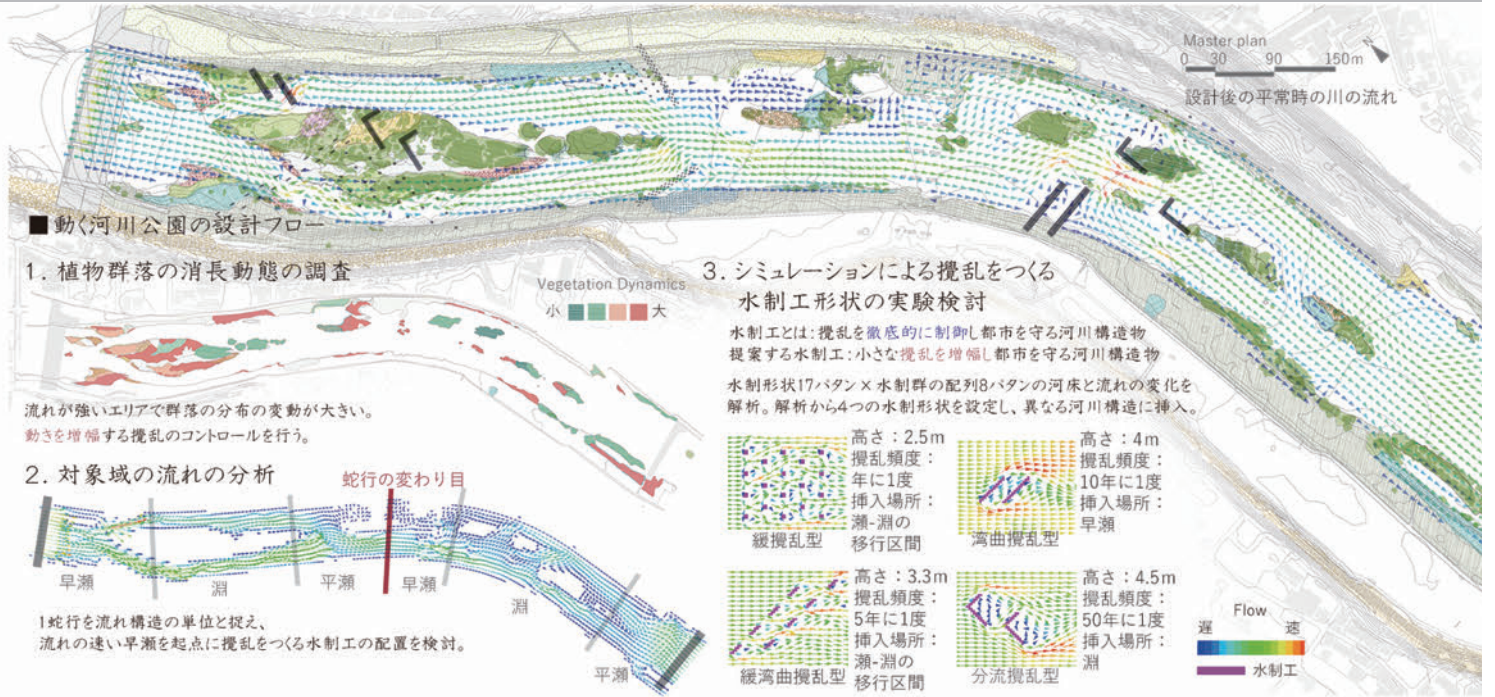

## 森になる川の遷り

千葉大学大学院 園芸学研究所 環境園芸学専攻

山崎 ひかり

yamazaki hikari

治水の発達により洪水攪乱が減少、遷移が進んだ川は秘境の  
ような緑地環境と洪水リスクを都市にもたらした。京都桂川  
に植生調査・シミュレーションを行い「動く河川公園」を提  
案。新たな攪乱のコントロールにより都市を守るインフラと  
攪乱がつくる植生の変化がつくる動く空間の設計を試みる。

4. 簡易シミュレーションによる50年間の公園の河床の変動解析  
 設計した水制群の経年変化を簡易的に検証。単調だった水際は多様な形態に。

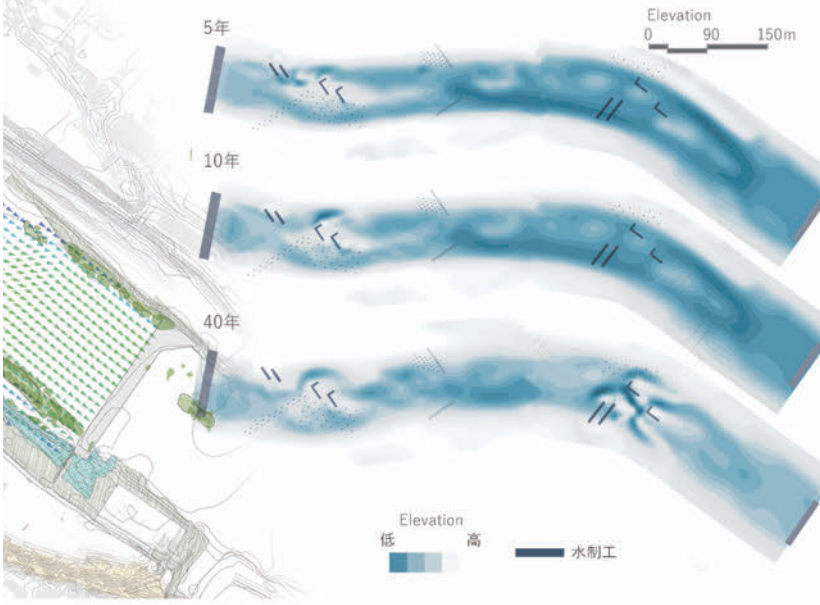

5. シミュレーション結果から植生動態を予測  
 洪水リスクを高めるジャヤナギの中木群は減少。  
 遷移進行による高木林と攪乱増加による湿地帯増加。

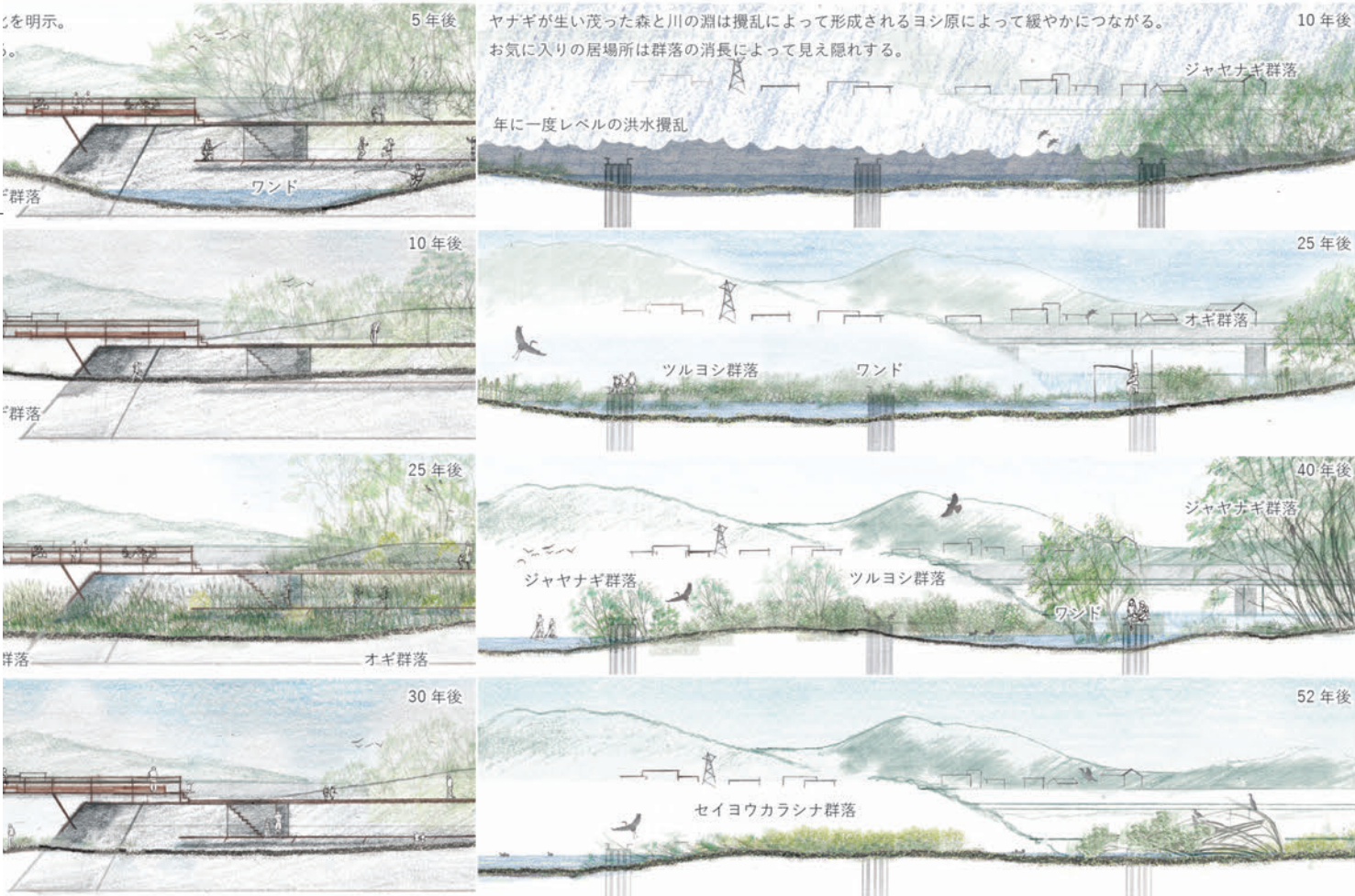
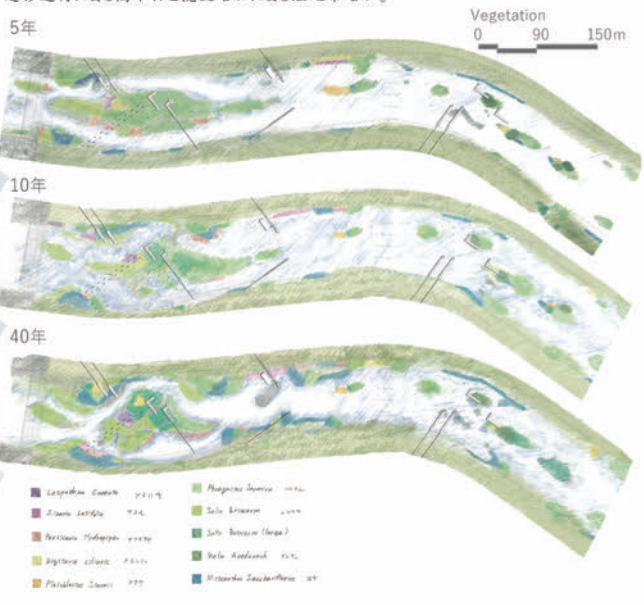

対象地: 京都府桂川10-12km 「河川の樹林化」が進行。川は森になりつつあり、新たな洪水リスクを生んでいる。  
 古くから治水と向き合ったこの地に、小さい攪乱を「増やす」ことで都市を守るインフラと、攪乱のコントロールによりつくられる動く風景を楽しむ河川公園「動く河川公園」を提案する。



# 学部卒業設計作品

Bachelor's

Master's

## 会葬の川 人の過ごす最期の時間の提案

江戸時代には水運の要であった小名木川から関東に向け水運を利用した遺体安置所の提案を行う

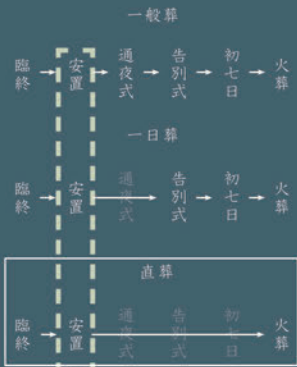

現状の遺体安置所



敷地詳細



現在の遺体安置所の多くは葬儀場の中に併設されている。上記のように無く無機質なものとなっている。現状の遺体安置所は面会時間が決まっており、その空間で故人と時間を共有することは難しい。

小名木川は東西に江東区を横断しておりその直線系は非常に人口적이다。小名木川の川沿いには「おのみち」と呼ばれる遊歩道が広がっており整備されている。葛橋開門より東側は水位のレベルまで降りることができるが西側は護岸上に遊歩道が存在する。

この遊歩道は地盤レベルより5m下に位置しておりここにはスロープや階段により降りることができる。しかし葛橋開門を地帯にして「おのみち」は途切れてしまっており、小名木川沿いの田中川から隅田川まで歩き続けることはできない。



近年都市部の葬儀は変化しており通常の一般葬から通夜式を行わない一日葬や通夜式、告別式を行わない直葬が増加しており、平成27年度の関東の葬儀の約4分の1がこの一日葬や直葬である。だがどの様な葬儀の形であっても安置は行わなければならない。法律により最低24時間の安置は義務付けられている。直葬の場合安置したの安置所から火葬場に行きその後納骨し葬儀は終わる。この場合もっとも重要な要素であるのは遺体安置所となる。

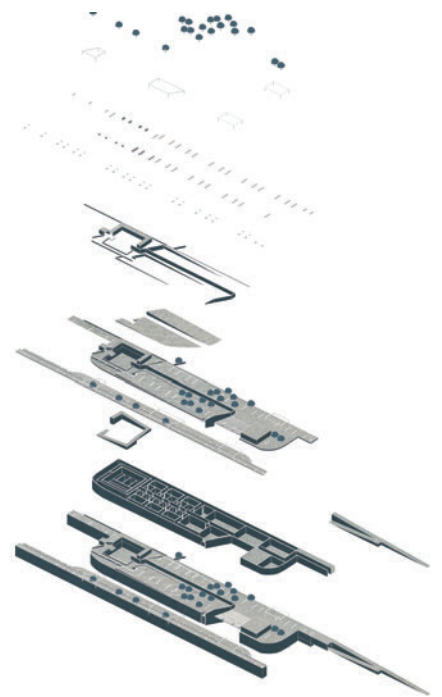
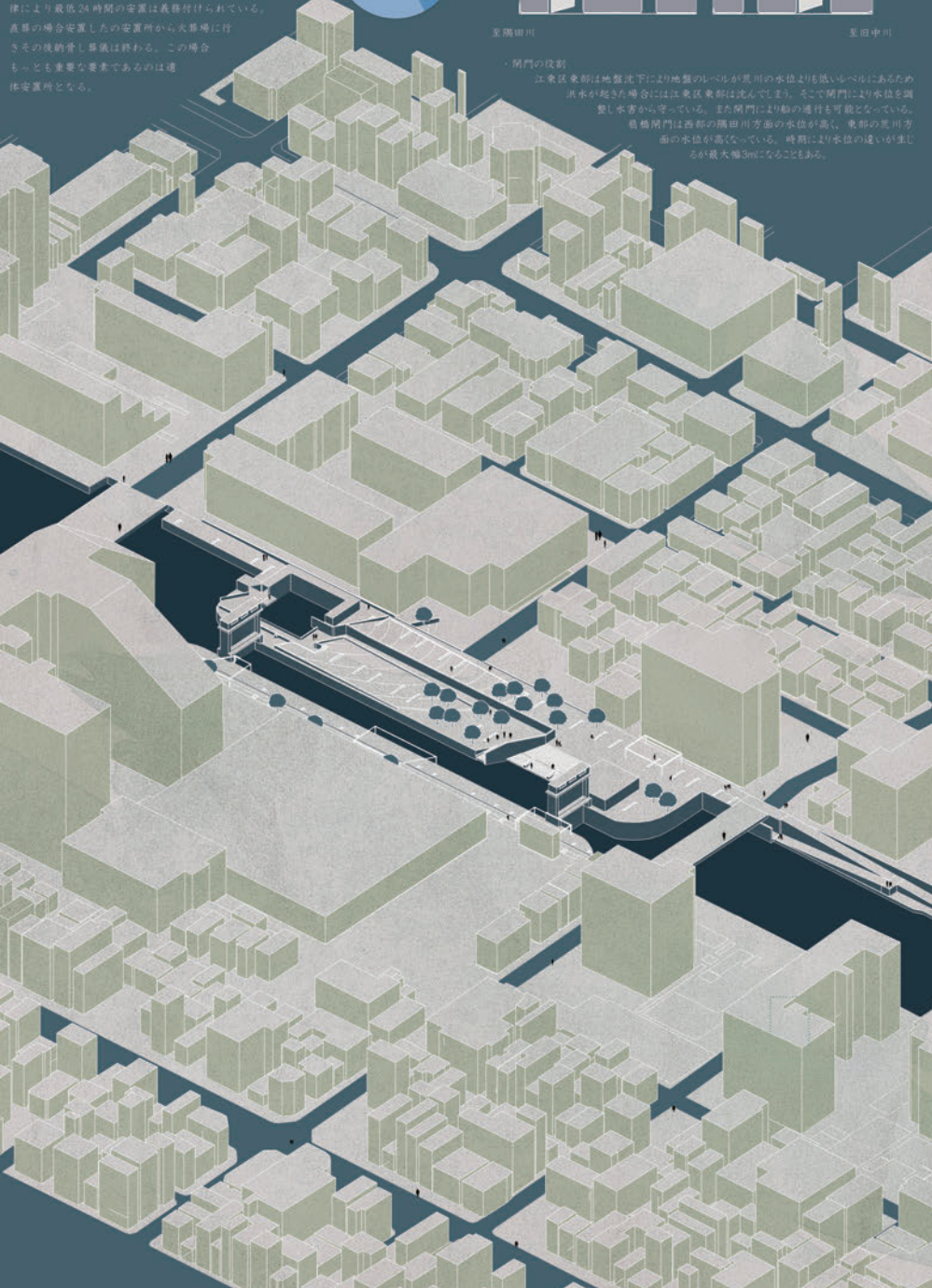

# Bachelor's design work

So Mizutani

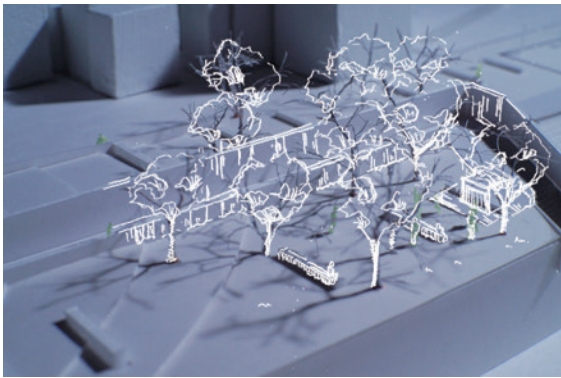
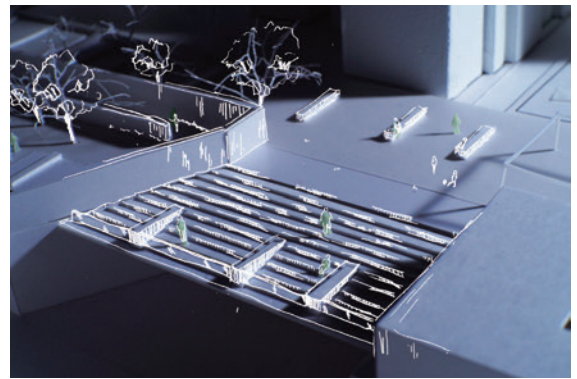
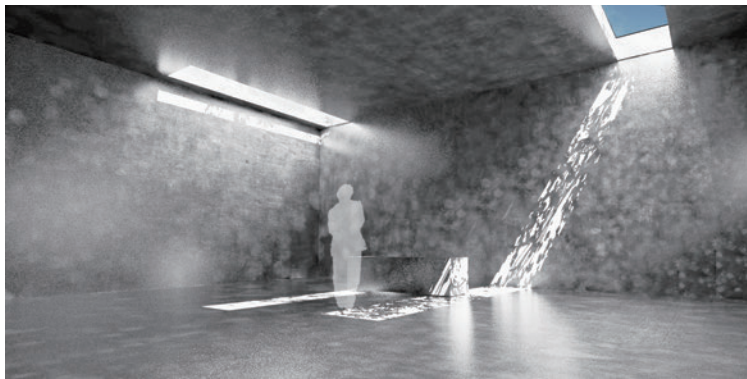
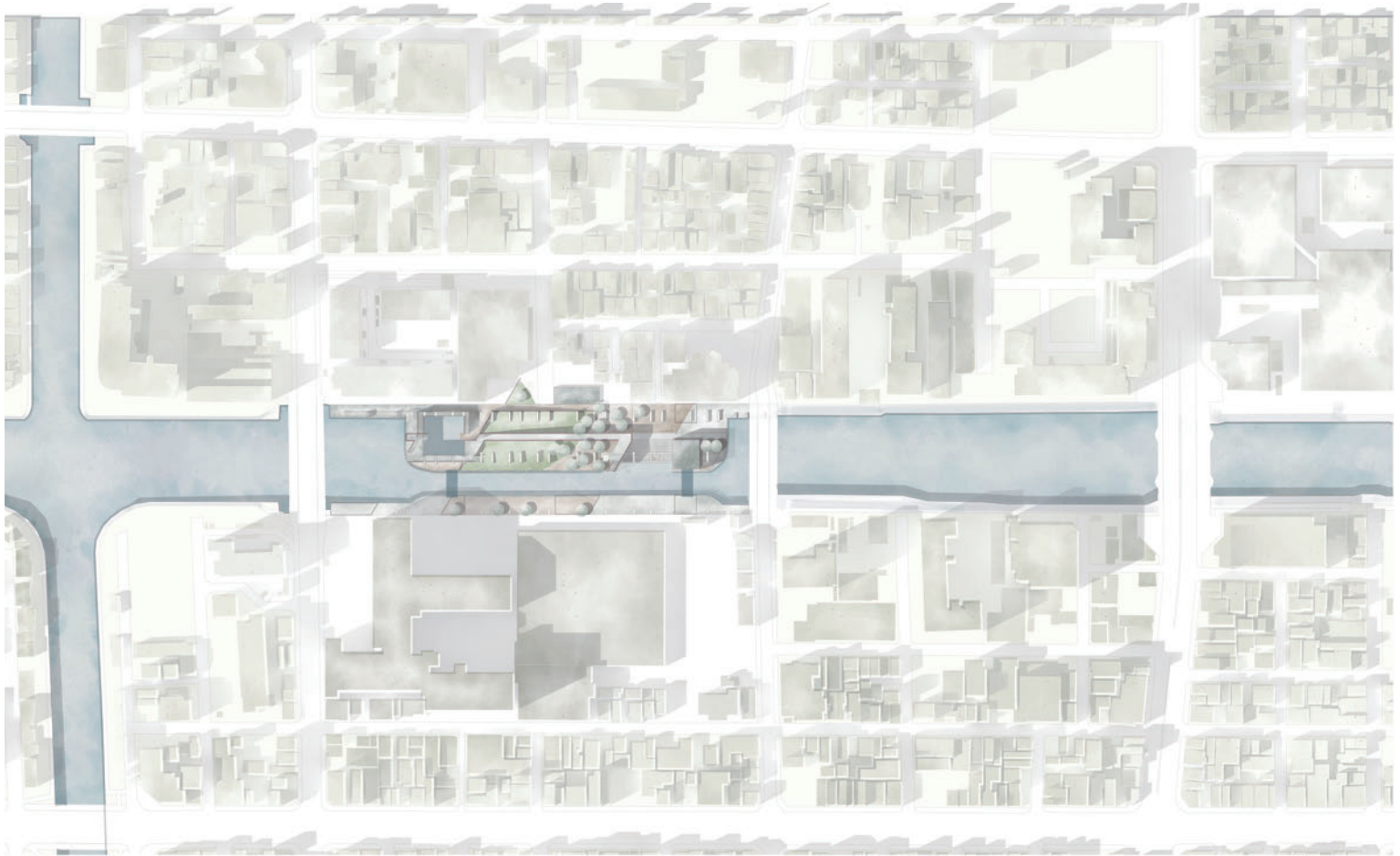



# 01 緑地環境学基礎実習 木下剛

## Landscape Architecture Fundamental Studio

Instructors: Takeshi Kinoshita and professors in LA course

This is fundamental studio that a student trains basic skill to understand and present regarding space and environment through field works and practices such as sketching, drawing, and site visit to historical places and fundamental work of landscape architecture and lectures of landscape science.

空間や環境を把握，構想，他者に伝達するための基礎的なトレーニング、緑地環境学の実践的応用の現場に触れる。キャンパス内でのスケッチ・自在画を初めとして、戸定ヶ丘歴史公園・松戸中央公園・旧松戸宿・矢切斜面林の現地見学と現地見学報告会（3班に別れて実施）、空間造形の基礎（空間の読解，植物による空間造形，地形の読解と改変）とそれらを補完する、生物多様性、土壌と水、地域を知るための講義を実施した。

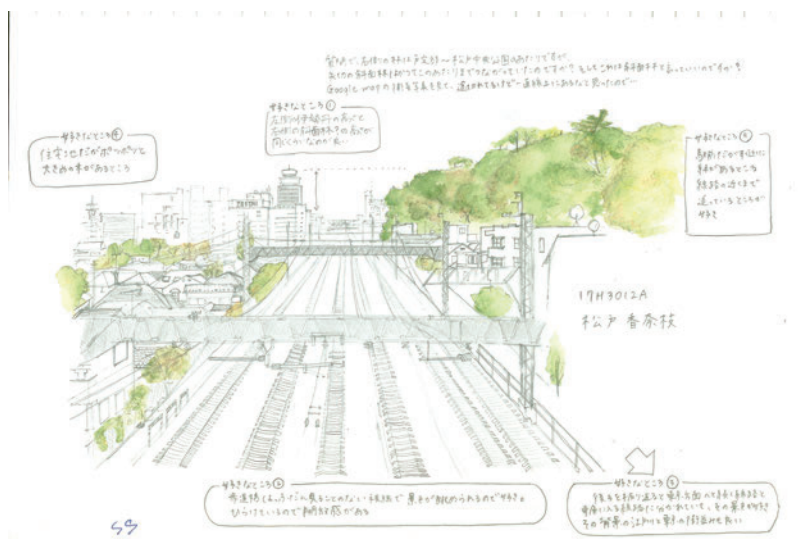

### Schedule

- OCT 3. Guidance (T. Kinoshita), Sketch and Hand drawing (Zhang, I. Kinoshita)
- OCT 10. Sketch and Hand drawing (Zhang, I. Kinoshita)
- OCT 17. Learning about biodiversity (Watanabe)
- OCT 24-NOV 14. Site Visit
- NOV 21. Presentation about site visit (Akita, Iwasaki, Omi, Shimoda, Takahashi, Yanai, Mishima, T. Kinoshita)
- NOV 28. Learning about importance of soil and water (Tang)
- DEC 5. Learning about region (Akita)
- DEC 12-19. Reading a space (Saito, Furuya, and Shimoda)
- JAN 9-16. Space with plants(Omi, T.Kinoshita)
- JAN 23-30. Learning about topography (Mitani, Honjo, and Kato)

- 10/3 全体ガイダンス【木下剛】，  
スケッチ・自在画【章，木下勇】
- 10/10 スケッチ・自在画【章，木下勇】
- 10/17 生物多様性を知る【渡辺】
- 10/24～11/14 現地見学  
【秋田，岩崎，近江，霜田，高橋，柳井，三島，木下剛】
- 11/21 現地見学報告会  
【秋田，岩崎，近江，霜田，高橋，柳井，三島，木下剛】
- 11/28 土壌と水の重要性を理解する【唐】
- 12/5 地域を知る【秋田】
- 12/12～12/19 空間を読む【齋藤，古谷，霜田】
- 1/9～1/16 植物のある空間【近江，木下剛】
- 1/23～1/30 地形を理解する【三谷，本條，加藤】

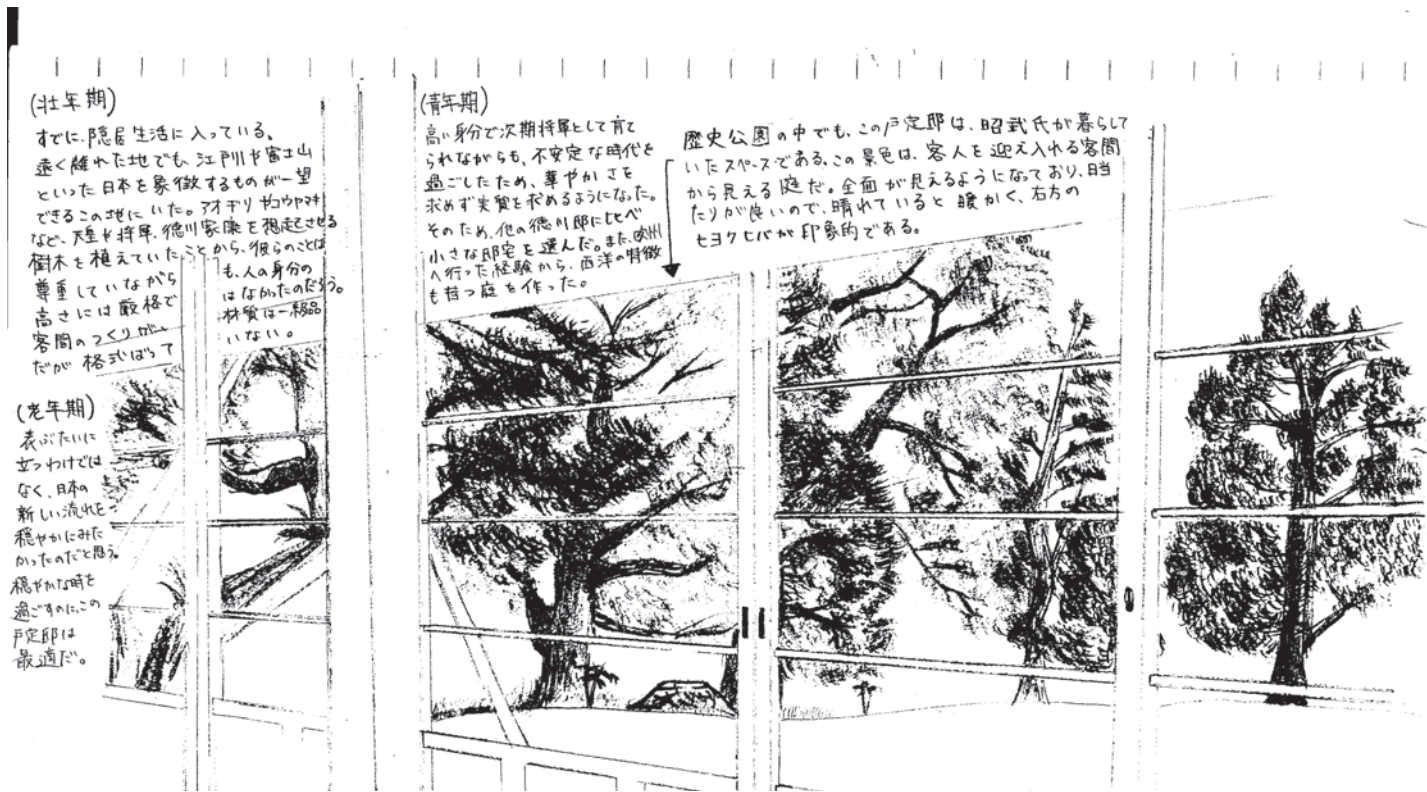

**Review:** Since the fundamental studio has various topics, Prof. T. Kinoshita, a coordinator selected several best works through the studio. it is important to carefully do any works in order to deliver your own idea. Those works above are well responding to our expectations.  
(Takeshi Kinoshita)

# 02 緑地環境学実習・前 近江

Bachelor's

Master's

## Landscape Architecture Basic Studio term-1

### Instructors: Yoshimitsu Omi

The studio provides a student with a basic knowledge and technique regarding green space, pruning, thinning operation, and weeding. The purpose is to understand transitional changes and characteristics of a green space and to learn maintenance skills for it.

緑地の構成を実地で理解し、設計意図を踏まえながら緑地を良好な状態に維持するための剪定や間伐、除草などの基礎的実習を行う。時間とともに成長・変化する緑地の特性を具体的に理解し、その構成を維持するための管理技術を修得することを目標とする。

### Schedule

APR 18. Basic Practice for green space maintenance -1:  
Maintenance for Bamboo forest

APR 25. Basic Practice for green space maintenance -2:  
Pruning of Camellia tree

4/18(火) 緑地管理の基礎実習(1) 竹林の管理

4/25(火) 緑地管理の基礎実習(2) ツバキの剪定

### Deliverable

- Working report for a research of changes before and after the green space
- Working report for a learning from the design and composition of the green space and working and maintenance skills.
- 作業前と作業後の緑地の状態の変化を調べ、レポートをまとめる。
- 当該緑地の設計意図・構成を理解し、適切な作業の方法、修得した技術についてまとめる



### 作業前の竹林

学生寮脇の斜面にある竹林において、緑地の管理を行う。密生したモウソウチクを間伐する。竹の更新を行うとともに、林床に明るさを取り戻す。作業にあたっては、近接する建物への影響を考え、どのような密度が適切であるか、考える。剪定鋏やノコギリなどを使ったことの無い学生が大半なので、道具の正しい使い方を学び、安全な作業の方法について学ぶ。



### 作業後の竹林と作業風景

作業後の環境変化を実感するとともに、作業上の失敗や不備について確認する。



### ツバキの管理（作業前と作業後）

プール脇のツバキの管理。仕切り植栽・遮蔽植栽の意味を理解しつつ、病虫害の発生を抑制するために密生した枝を剪定する。花期や花芽分化について理解し、作業方法について修得する。

# 03 緑地環境学実習・後 天野 / 木下剛

Bachelor's

Master's

## Landscape Architecture Basic Studio term-2 "Landscape design of a Pocket park enhancing an image of Matsudo "

Instructors: Makoto Amano, Takeshi Kinoshita

This studio aims landscape design proposal of a pocket park which enhances an image of Matsudo. The target site includes our school street between Matsudo station and Chiba University. A student is expected to find an issue and try to solve it and develop each landscape design. Finally, each student could present various ideas by each own way.

### 【条件】

- ① 松戸駅から大学へと向かう通学路のスペースを計画地とする。
- ② 施設用途・機能は自由
- ③ 面積は 500㎡程度を基本として、相模台公園を取り込む範囲まで OK。
- ④ 松戸の地域性を生かし（歴史・文化・生活・経済・・・）計画する。
- ⑤ 計画のポイントとなるキーワードを定めて、小空間を計画・演出する。

### 【手法】

- ① 計画地を見て、既存の周辺施設の調査分析を行う。
- ② どんな施設があればよいか、どんな機能が必要か、またどのようなネットワーク化がはかれるか、どんなまちづくりを図れるかなど、計画施設に合わせたプレゼン方法を導きだす。
- ③ 計画地を中心とした周辺への関係性を見出し、発想豊かな発信性のある空間とする。

### Schedule

- JUN 6. Guidance and site visit
- JUN 13. Keyword and concept making
- JUN 20. Short presentation
- JUL 4-14. Making presentation board
- JUL 18-25. Final Review

### Deliverables:

A1 1or2 sheets with title, concept, plan, and sketches

- 6/6 オリエンテーション・現地調査
- 6/13 計画のキーワードを定め、コンセプトを導く
- 6/20 1分間のプレゼンテーション(テキストのみのペーパーで発表)
- 7/4～7/14 プレゼンボード作成から仕上げまで
- 7/18～7/25 講評会(2回に分けて開催)

### 【成果物】

- ① A1 プレゼンボード 1～2枚
- ② タイトルとコンセプトは必ず表記する。
- ③ 平面図とスケッチは必ず作図、その他必要な図面を作成。





Final Review

The Best Work - "White City, Matasudo" by Aoi Matsumura

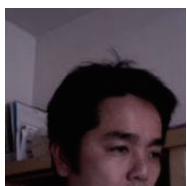

Makoto Amano  
どんごこ設計室

**Review:** We evaluate that this work successfully delivers clear image as a face of Matsudo from the site to University and station. Based on "white" color of spaces, various seasonal colors are added, which is good enough expression to make an impression. In terms of her planning and design work, she could comprehensively present her idea from interior, architecture to regional scale. (Makoto Amano / Takeshi Kinoshita)

# 04 環境造園実習 1・前 近江

Bachelor's

Master's

## Landscape Architecture Studio-1 term-1

Instructors: Yoshimitsu Omi

The studio provides a student with knowledges regarding garden and green space maintenance and relationship between a architecture and its site and environment through the practice in the gardens and green spaces in the university campus.

庭園・緑地の施工・管理、建築構造物と敷地及び周辺環境の理解、植栽構成と管理について学ぶ、小規模緑地の施工・管理の在り方をキャンパス内の各庭園・緑地の管理をととして学ぶ。

### Schedule

OCT 16. Lecture

OCT 23. Maintenance for Gardens

French Garden:

Flowerbed arrangement for summer and autumn,

Foundation making for winter flowerbed, edge

arrangement work and weeding for lawn

Italian Garden:

Garden restoration work for footpath

OCT 30. Working report

NOV 7,14. Maintenance for Gardens

Italian Garden:

Pruning of Japanese umbrella pine in the Italian Garden

NOV 21. Pruning of Azalea

Deliverable

Working report for purposes and role in green area maintenance



枝透かしにより樹冠内に日射が入りようになる（左；作業前、右；作業後）



芝生の縁きり（左；作業前、右；作業後）



タギョウショウのもみあげと枝透かし（左；作業前、右；作業後）



ツツジの透かし剪定（左；作業前、右；作業後）



# 05 環境造園実習 1 ・ 後 近藤 / 齊藤

Bachelor's

Master's

## Landscape Architecture Studio-1 term-2 "Design Development of Basic Studio in Matsudo"

Instructors: Taku Kondo, Yukihiro Saito

Based on proposals resulted in former studio lecture, supposing users or citizens concretely, considering regional situations from viewpoints of wider areas to neighborhood areas, students have to make a concrete and realizing presentation with drawing in detail. For realizing presentation students ask teachers frame work of the proposal with nature environment and social feasibility. Former studio lecture presentations varies from each students, teachers make advices considering it. Presentations are evaluated from viewpoints not only of beautiful sketches and models , but also of process of making ideas, solution methods, choices and the presentation method of information.

本実習では前期の各自の提案を前提に進め、更に具体的な利用者を想定し、広域から近隣までの地域状況を踏まえて、具体的で実現性の高い空間を詳細に設計する。その際、計画を取り巻く自然環境要素や社会的根拠が極めて大切な事業成否の判断材料となるため、それら一連の検討を講師と共に進めていく。また前期実習の提案内容は各自で異なるため、エスキスにおいて方針や計画及び設計の指導を行うこととする。本実習は綺麗なスケッチや模型を作成することだけを求めている訳ではなく、アイデアや解決方法の検討、そして伝えるべき情報の選別とその表記方法なども重視しており、それら全体を評価対象とする。

### Schedule

- 12/4 : Guidance (outline explanation of theme、 field survey)
- 12/11:esquisse 1  
(evaluation of former lecture results、 setting new theme and consideration of proposal for solution)
- 12/18:esquisse2 (consideration theme trying to write plan, section, elevation, concept figure, sketch)
- 12/25: intermediate presentation (presentation using concept figure ,drawings and related documents)
- 1/15: :esquisse3 (modifying drawings and concept figure, consideration of model )
- 1/22: esquisse4 (consideration of presentation layout about drawings, models, pictures of models, sketches)
- 1/29: pre-presentation (Oral presentation toward regular teachers)
- 2/5: final presentation (Oral presentation toward guest designer modifying former presentation, receiving guest comments )



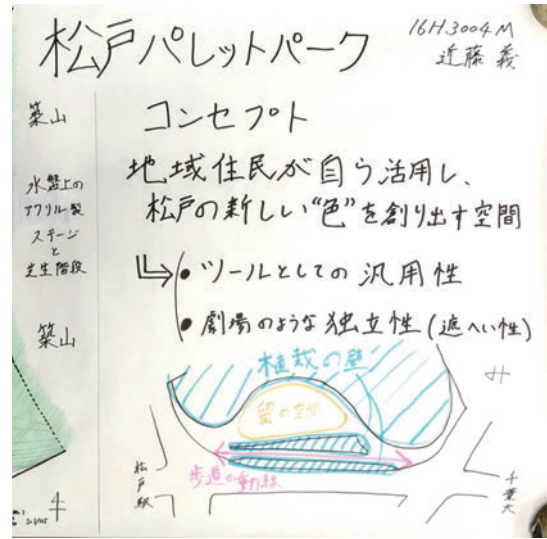

The Best Work - "Pallet park Matsudo" by Yoshi Kondo

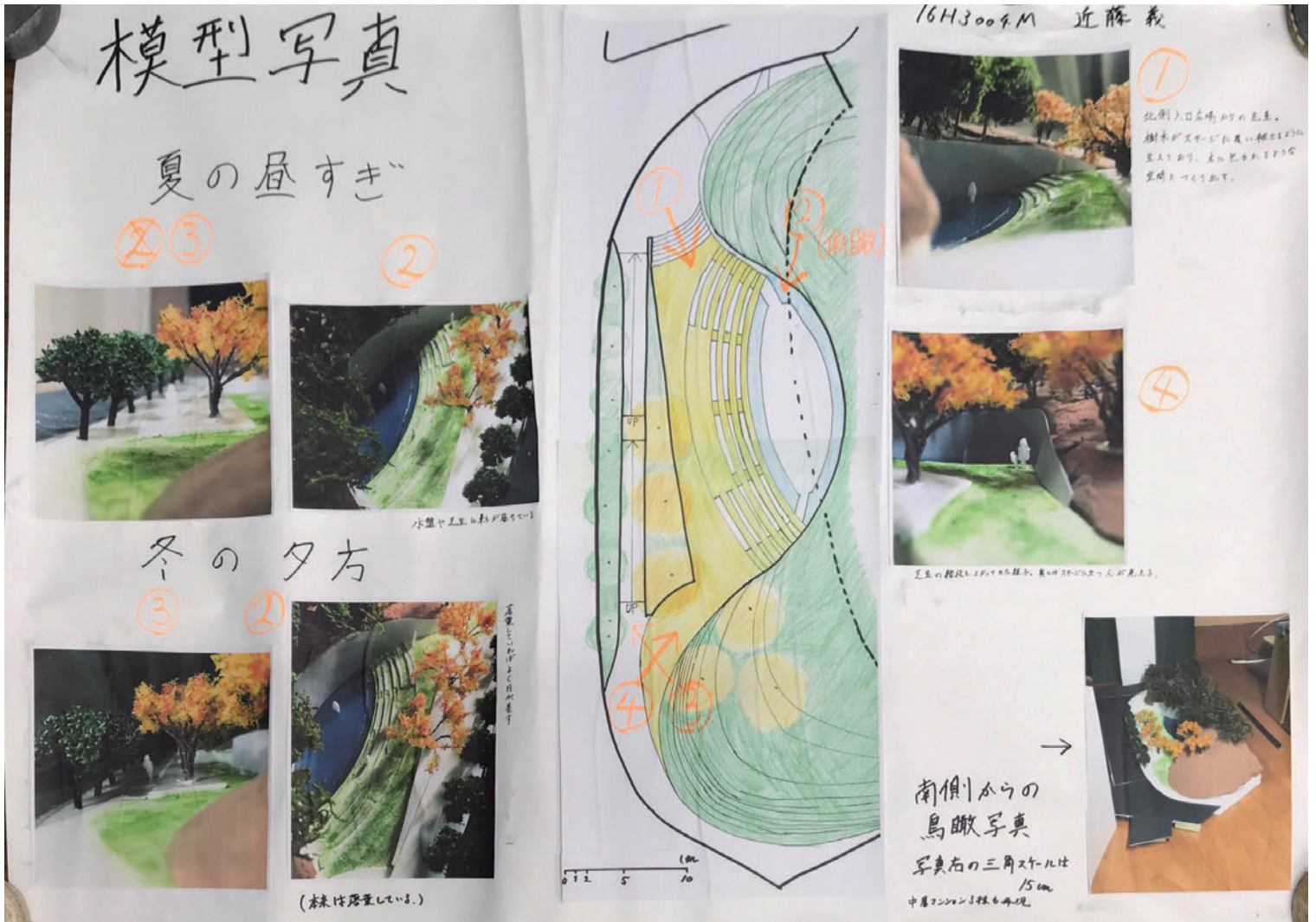

Taku Kondo  
Taku Kondo design office

**Review:** in former studio lecture, he proposed event space like outdoor theater sunken from the neighborhood ground level. In this studio, he analyze and evaluate directions of theater, environment of mountains (forests) surrounding it, relationships with side walk, he rotate the event space at an angle of 90° considering avoiding sunshine and visual line of pedestrians walking on side walk. He planted deciduous trees around the theater having sunshade in summer and having sunshine in winter. His proposal which we can notice the significant improvement from the former studio proposal, which we can notice typical landscape design characteristics clearly is so excellent. (Taku Kondo/ Yukihiro Saito)

## Landscape Architecture Studio 2-1 "Designing Vernacular Landscape in Urban Space"

Instructors: Hideyuki Ishii, Toru Mitani TA: Yusuke Suzuki

Every place has its own characteristics; a specific atmosphere, landform, or the unique manner of life. 'Is it possible or not to create the place-specific design that appears "vernacular" even among the urban context?' is the query of this studio. The project site is the property of Aoyama municipal condominium - north wing - that is expected to be rebuilt. Students are required to design the open space and lower stories of the new condominium as well as to propose the activity programs.

### 都市空間におけるヴァナキュラー ランドスケープデザイン

どのような場所でも丁寧に向き合うとその場にしか流れていない独自の時間、土地の形態、人々の営みといった固有性があることがわかる。都心の中でもその土地と人でしかできない場づくりができないだろうか？本実習では都営青山北アパートの一部の建替に伴うオープンスペースと低層棟のデザインを行い、場のデザインとともに施設のプログラムも合わせて提案する。

#### Schedule

- 第1回 4/7(金) 現地調査 site visit)
- 第2回 4/14(金) リサーチ発表  
presentation about resarch
- 第3回 4/21(金) エスキス Esquisse -1
- 第4回 4/28(金) エスキス Esquisse -2  
Mid-term review
- 第5回 5/12(金) エスキス Esquisse -3
- 第6回 5/19(金) エスキス Esquisse -4
- 第7回 5/26(金) 最終講評 Final Review
- 第8回 6/1(金) ゲスト講評 Guest Review

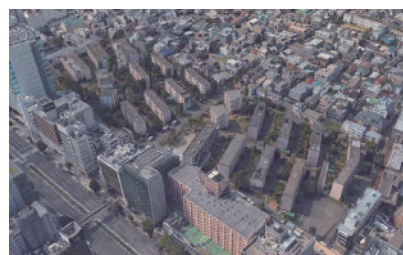

The Best Work - "A Concert Hall for Aoyama Community" by Mao Mukohyoshi

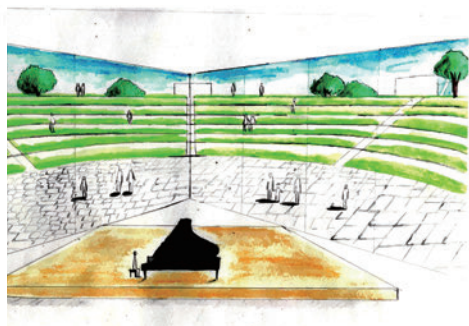
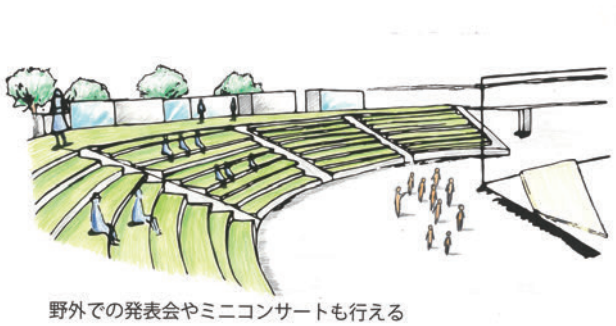

CONCEPT  
住宅と音楽が融合した新しい文化複合施設

DESIGN

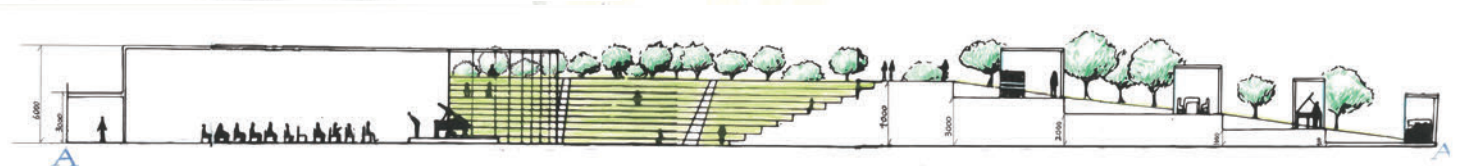
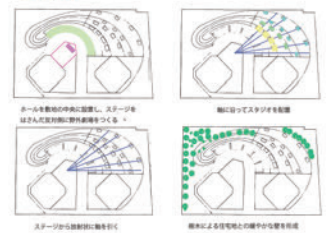

Hideyuki Ishii  
STUDIO TERRA

**Review:** This proposal is the marriage of the culture of music and the residence for creating a new style of urban life. A single small concert hall for residence-use is located at the center of the site. The player stage appears against the wide green space, that could be used as an amphitheater. A group of small studios are laid out around the north half of the site where residents can use for their music exercise or music school, then the communication among residents or between residents and visitors would be increased. (Hideyuki Ishii / Toru Mitani)

## Landscape Architecture Studio 2-1

### "Management and Planning of public space"

#### ~ Enhance the charming of the space by connecting Tojo-tei and Edo river ~

Instructors: Shigeto Yanai, Noriko Akita

Matsudo had flourished as distribution routes and bases. Because there had Mito historical road, it was connected Edo, Matsudo with Mito, and Fresh fish road, it was connected Tone river with Edo river. Tojo-ga-oka, where Mastudo campus of the faculty of horticulture and the Tojo-tei, has built prosperity through connection with the surrounding areas by the road. However, there is currently no relation between surrounding land use and Edo river.

Therefore, in this studio, we aimed to propose; construction of a space connecting Tojo-ga-oka and Edo river, creating new attractions around Tojo-ga-oka, integrating the value. The main goal of this studio was to propose measures to utilize such space and maintenance and management. This studio consisted of literature survey, field survey, and interviews with people concerned. In this way, the students learned the historical space transition, the history of Tojo-ga-oka park and Edo river, and by the significance of revival, create a new attraction and landscape of the area, and maintain a methodology for sustainably managing. They also learned how to proceed by conducting surveys and proposals mainly on group work.

Furthermore, the presentation was opened for local government members, local residents and communities. Therefore, the students were able to obtain the evaluation on the regional perspective regarding the creativity and feasibility of the proposal.

#### Schedule

##### 【1st phase】

Implementation of field survey and interview survey  
1st:Explanation of the study, grouping, Collection and arrangement of materials

2nd:Lecture by the people concerned

##### 【2nd phase】 Review of master plan

3rd:Setting of the target place, organizing/analysis of the target place, discussing

4th:Interim report of the basic concept of the proposal, Proposal of management/operation method

5th:Summary of the survey results, planning the proposal policy, determining the contents of the proposal

##### 【3rd phase】 Review of site plan

6th:Additional field survey/interview survey, announcement of site plan

7th:Preparation of public presentation materials

##### 【Last phase】 presentation

8th :Implementation of public presentation



Site map by Google Maps

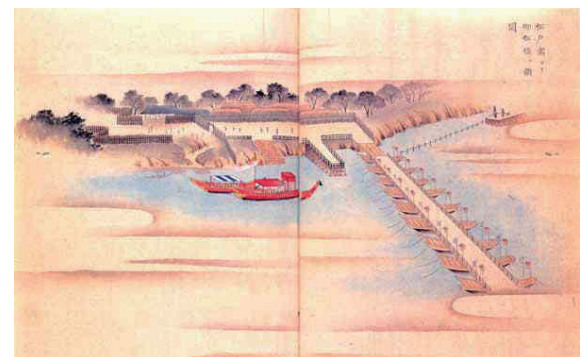

Temporary boat bridge established in Matsudo checkpoint at Edo era



The Best Work - "Matsudo ja night" by Hidemi Okuyana, Chie Sato, Tomomi Seki, and Atsuto Nabeshima



Public Presentation



Field Survey



Matsudo city staffs and residents came to the public presentation

## Landscape Architecture Studio 2-2 "Future Urban Waterfront"

Instructors: Naoko Sakamaki, Ryosuke Shimoda TA: Minami Musha

The center-city of Tokyo in the present used to be 'the city of water' in Edo period with the widely-spread network of water. However, in the modern period, most of waterfronts had been buried and the urban structure had been converted from water-basis to car-basis city. Water had gone away from the urban life. In this practice, we intended to read the historical context of water-basis city structure and to plan the regional area. In addition, we lead the design of the park with details. For these objectives, we selected Asashio canal waterfront in Harumi-Tsukishima area as the project site where rapidly developed for mix-use. In particular, we specified Reimeibashi-park for the design site. As for the design process, we organized phases from research, planning to design. Basing on the twice site visits, students found the potential and improving points of the site and developed them into the spatial design. At the final presentation, each student proposed the plan and design toward on-campus professors and the guest critique members.

### 未来の都心の水辺

現在の都心部は、江戸時代には水網の発達した水の都だった。しかし近代に入ると水辺空間の多くは埋め立てられ、自動車道を下敷きにした都市に変わり、水は人々の生活から遠ざかっていった。本実習では、東京の歴史的な文脈を紐解きながら水辺の魅力を再生させるべく、まち全体を捉えたプランニングとデザインを行う。対象地は、水とともに複合開発が進む湾岸部、月島晴海地区の朝潮運河沿岸とし、ランドスケープのプランニングによって整備方針をたて、運河沿いの黎明橋公園の空間デザインを提案する。作業の進め方は、現地調査での分析や各自の抱いた印象を大切にしながら、具体的なデザイン提案を行う。最終プレゼンテーションは、学内教員やゲスト講評者を迎えての発表とした。

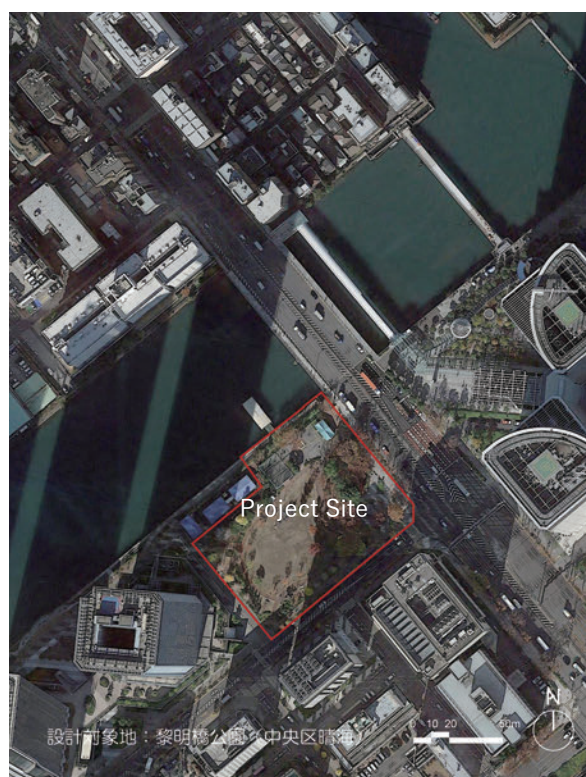

### Schedule

- 6/9 Research Phase :  
Guidance + Site visit- ①  
(Analysis of good points and improving points)
- 6/16 Research & Planning Phase : Site visit- ②  
(Scaling space, Planting analysis)  
+ Concept Making
- 6/23 Planning Phase : Pin-up ①  
5minutes/person (Concept + Images +Plan)
- 6/30 Design Phase : Esquise-1  
Design Development (Plan + Section)  
+ Guidance for Elevation and perspective sketches  
+ Lecture about 'Case study of Waterfront Urban Landscape'(by Prof. Shimoda)
- 7/7 Design Phase : Esquise-2  
Design Development (Section + Elevation + Detail)  
+ Lecture about 'Practice as Landscape Architect' (by Sakamaki)
- 7/14 Design Phase : Pin-up ②  
5minutes/person (Plan + Section + Elevation  
+Perspectives)  
+ Guidance for Making Models (S=1/500, S=1/200)
- 7/21 Design Phase : Esquise-3  
Preparation for Final Review
- 7/28 Final Review

### Deliverables :

- 1) Presentation panel (A1, 3sheets) included below:  
Title, Concept notes, Main perspective, Diagrams, Site images, Plan(S=1/300), Main Section(S=1/100), Detail Sections(S=1/50), Elevation(as needed)
- 2) Models (S=1/500 and S=1/200)



Research Phase

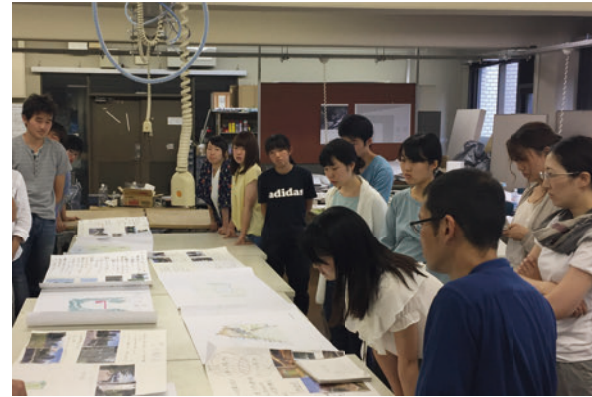

Planning & Design Phase



Final Review

The Best Work - "Urban Bach" by Masahiro Yamashita

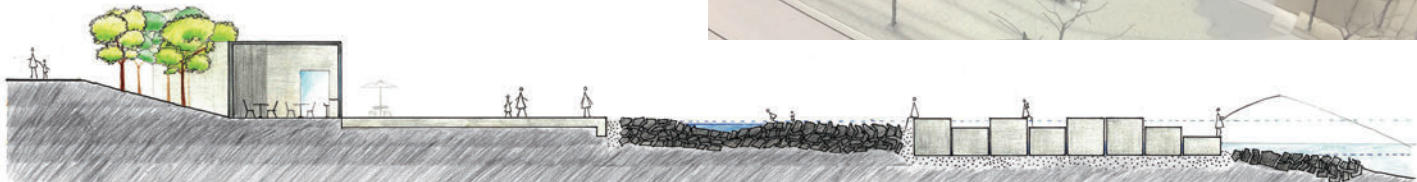
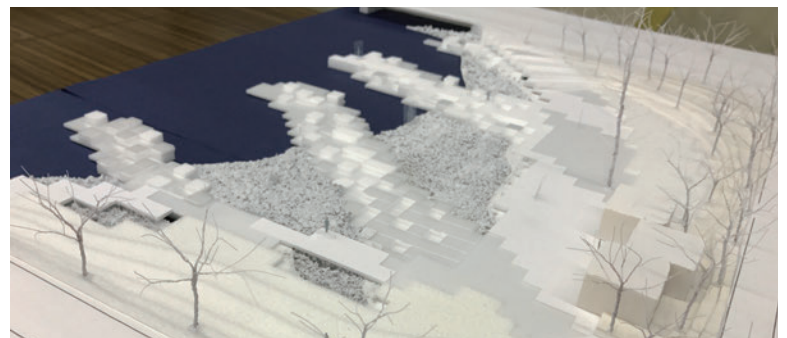
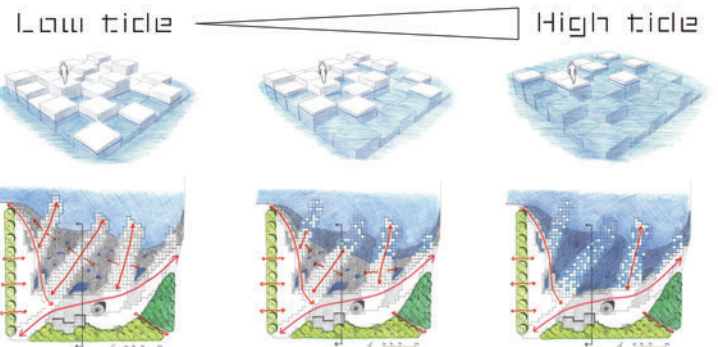
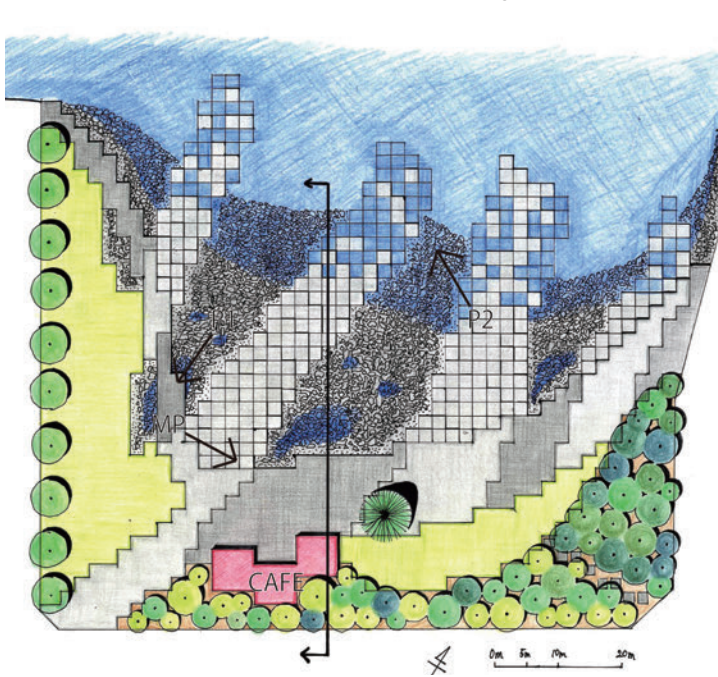

Naoko Sakamaki  
FIELD FOUR DESIGN OFFICE

**Review:** We placed the high value toward the design work for the sensitive analysis and emotional design utilizing the delicate landform of the only 2-meters difference in level at the site and the 2-meters depth of the sea. For scaping this geographical character onto the urban context, he is applying the existing ebb and flow into the scenery, furthermore, he put urban activities into it. I found the power of landscape in the fusion of the natural principles and the urban life. (Naoko Sakamaki / Ryosuke Shimoda)



# 09 環境造園実習 2 - 2 近江

Bachelor's

Master's

## Landscape Architecture Studio 2-2

Instructors: Yoshimitsu Omi

The studio aims that a student could learn about sustainable landscape construction and management technique based on relationship among architectures, facilities, and green area in the university campus. Those practices are expected to apply for landscape design work.

大学キャンパス内での建築・施設と緑地との関連性を理解した上で、持続可能な施工・管理技術を習得する。1年次からの一連の施工・管理実習の仕上げとして管理技術の向上も目標ではあるが、建築物と植栽との関連性を考えつつ、植栽管理のあり方を考え、製図実習に活かす知識を修得することも目標となる。

### Schedule

- APR 14. Pruning of Otometsubaki Camellia
- APR 21. Maintenance of Camellia sp. and Camellia sasanqua
- APR 28. Maintenance of the Italian Garden: pruning of Japanese pine tree leaves in spring
- MAY 2. Site visiting at Urban Green Exhibition
- MAY 12. Pruning of Enkianthus perulatus (ドウダンツツジ)
- MAY 26. Review for the studio practices
- JUN 3. Summer activity at the Sunken Garden

### Deliverable

Working report for purposes of vegetation management especially focusing on cutting, pruning of each species.

- 4月14日 オトメツバキの剪定
- 4月21日 ツバキ・サザンカの管理
- 4月28日 イタリア式庭園の管理（マツのみどりつみ）
- 5月2日 全国都市緑化フェア視察
- 5月12日 ドウダンツツジの刈り込み
- 5月26日 雨天のため、ビデオを見ながら、実習をふりかえる
- 6月3日 サンクガーデン夏の会に振替

### 【成果物】

植栽の設計意図を理解した上で、植栽幅や樹高、透かしの有無などについて考え、管理目標を考える。さらに適切な作業の選択（刈り込み、透かし剪定、切り戻し剪定などの選択）・作業の技術的ポイントについてレポートにまとめる



ツバキの剪定（左；作業前、右；作業後）  
建物内への日照を考えながら切り戻し剪定・透かし剪定を行う。



ドウダンツツジの刈り込み（左；作業前、右；作業後）  
建物の腰植植栽の維持管理を考える。設計意図を理解しながら、植栽の幅や高さの管理目標を考える。



イタリア式庭園の管理  
タギョウショウのみどりつみ（左；作業前、右；作業後）

タギョウショウの特性・美しさを維持するために、みどりつみを行う。  
また、イタリア式庭園の空間を狭く感じさせないためにも、タギョウショウの大きさを維持していく必要があるため、切り戻し剪定を行う。  
残念ながら、現状のタギョウショウは、理想とする大きさよりもかなり大きくなってしまっている。管理上の課題を理解し、今後のあり方を考える。

## Landscape Architecture Studio 3-1 "Conceptual Urban Planning based on historical context"

Instructors: Takuya Miura, Konomi Ikebe

We are looking at a city and village based on their historical context. Prior to regional proposal, it is important process that we study a direction reading the regional historical context. There is no single answer for it but various approaches toward the urban planning proposal. In this studio, we expect that a student could learn about how to propose concept design based on research method of reading a historical context regarding a site.

We had various ways of seeing the site such as checking a character of a slope, proposal of evaluation for a temple and shrine as a cultural core, proposal of an attractive "darkness", and cultural revitalization based on vacant houses.

### 歴史的文脈にもとづく まちづくりコンセプト提案

都市や集落は、様々な歴史の変遷を辿り今日みられる姿となっている。地域の環境整備の提案にあたっては、まず地域の歴史的な文脈を読み解き、これを踏まえた上でその進むべき方向性を検討することが重要なプロセスとなる。歴史的な文脈の解読は決して単一の答えがあるのではなく、多様なアプローチがあり、アプローチに応じて地域に対するまちづくり提案も様々なコンセプトが生まれる。本演習では、歴史的な文脈の解読手法の取得と実践、各自の捉えた歴史的な文脈に基づく環境整備のコンセプト提案を実施した。また、対象地は自由として、コンセプトとストーリーに重点を置いた内容としている。自由なテーマ設定だけに、多様な着眼点があり、坂に着目して勾配を測り分類して活用提案を行うもの。寺社を小さな文化交流拠点として寺町の現代的な役割を探るもの。まちの照度に着目し、魅力的に「暗くする」提案。飲食街・観光地化していることを課題として空き家等を活用した文化再生の提案などである。



Project Site - Kagurazaka, Shinjuku ward, Tokyo Metropolitan Area

### Schedule

- 01 Guidance, Grouping
- 02 Research about historical and geographic context on Kagurazaka district, concept making
- 03 Site visit and concept development
- 04 Presentation about concept design
- 05 Schematic design for the urban planning 02
- 06 Schematic design for the urban planning 03
- 07 Schematic design for the urban planning 04
- 08 Final Review with local community and professional designers

- 第1回：班分けガイダンス：演習の目的、内容の説明
- 第2回：神楽坂界隈の簡単な歴史と地形を知る：コンセプト検討素案検討  
(古地図との対応、等高線、路地の成立過程など)
- 第3回：現地視察、コンセプト案の設定（現地集合、現地解散）
  - ・地元住民による簡単なご案内
  - ・コンセプトと対象候補地（案）の選定
- 第4回：コンセプト案の発表
  - ・歴史的な特性とコンセプト、対象地のまちづくりストーリー提案検討
- 第5回：計画対象地におけるまちづくり提案の検討2：個別指導
  - ・ストーリーと必要素材の検討
- 第6回：計画対象地におけるまちづくり提案の検討3：個別指導
  - ・プレゼン手法の検討
- 第7回：計画対象地におけるまちづくり提案の検討4：個別指導
  - ・各自の素案の発表
- 第8回：課題の発表と講評
  - ・地元住民の方、環境デザイナー等による講評

The Best Work - "Making a connection with Two Kagurazakas " by Tomomi Hikasa

<h2 style="text-align: center;">2つの神楽坂を結ぶ</h2> <p style="text-align: center;">15H3047M 日笠朋美</p>	<h3>神楽坂の魅力・課題</h3> <p>&lt;魅力&gt;</p> <ul style="list-style-type: none"> <li>・昔ながらの街並みが残っている。</li> <li>・若者、お年寄り、外国人など様々な人がいる。</li> <li>・人の賑わい</li> </ul> <p>&lt;課題&gt;</p> <p>大久保通りが神楽坂を二つに分断してしまっている。 →連続した賑わいが途切れてしまっている。 人の行き来の妨げになっている。</p>
	<h3>神楽坂の現状</h3> 
<h3>大久保通り拡幅計画</h3> <p>片側1車線、幅員約18mの道路 →片側2車線、歩道幅員6m、総幅員30mに</p> <p>すでに用地買収などが進んでしまっていて、工事自体を中止にすることは難しい....</p> <p>しかし、大久保通りの交通量は年々減少、都心部主要道路の交通量も横ばいまたは微かに減少傾向にある。</p> <p style="text-align: center;">↓</p> <p>車線数は1車線のままに、できたスペースをうまく活用する</p>	<h3>2つの神楽坂を結ぶ</h3> <ol style="list-style-type: none"> <li>1. 人の賑わいを途切れさせない →大久保通りを新しい神楽坂の名所にする</li> <li>2. 物理的に結び、人の行き来を活性化させる →歩道橋を設ける</li> </ol>
<h3>1. 歩道の庭</h3>  <ul style="list-style-type: none"> <li>・ 神楽坂にはないまとまった緑</li> <li>・ 住民に管理してもらい、住民同士のコミュニケーション</li> <li>・ メディカルセンターから人を誘致</li> </ul>	<h3>2. 歩道橋</h3>  <ul style="list-style-type: none"> <li>・ 緩やかなスロープ →自転車、ベビーカーなどが通れるように</li> <li>・ 細めのらせん階段 →新たな視点場</li> <li>・ 車道上空は広場にする</li> </ul>



**Takuya Miura**  
マヌ都市建築研究所

**Review:** Kagurazaka district is a street extending from Edo castle to North West direction and a part of regional street between Edo castle and Daimyo compound in suburbs. The district is located on hilly area so that it is called "Kagurazaka" with major slope. However, currently this district is divided by East West street "Okubo Street". This proposal is evaluated as a unique approach that she focused on the differences of the characters of north and south side. Based on the clear differences, those will be applied for enhancement of the both areas to activating people's circulation and communication. Although other proposals are done from the point of view of tourist, this proposal is based on the local community. More design development regarding the crossing point will be expected. (Takuya Miura / Konomi Ikebe)

## Landscape Architecture Studio 3-1 "Sustainable Urban Planning by Green Infrastructure"

Instructors: Masayuki Mukohyama, Katsunori Furuya TA: 張 駿馳

### Schedule

- 01 Guidance
- 02 Site Visit and Research, lecture by Koto ward CIG group
- 03 Esquisse #1 selection of project site
- 04 Esquisse #2 concept making
- 05 Mid-term presentation
- 06 Esquisse #3 design strategy and schematic design
- 07 Pin-up and presentation of each proposal
- 08 Final Presentation

The project area is the bay and inland area of Koto ward where many facilities are concentrated for TOKYO 2020 Olympic and Paralympic game.

In newly reclaimed bay areas, there are many new condominium buildings have been constructed and the population is expected to increase. In contrast, inland area has mosaic land uses of newly developed area and high density small wooden building with high risk of fire and flooding disaster since the most of the area is under sea level. However, this area has great potential if the existing water body and green area are enhanced. In this studio, a student is expect to find issues and environmental resources that could be utilized as a green infrastructure for sustainable city.

## グリーンインフラの取組による持続可能なまちづくり

2020年東京オリンピック・パラリンピック大会会場が集中し、注目を浴びる江東区臨海部。その内陸部を対象フィールドとする。

新しく埋立て、新築マンションが続き、子育て世代の新住民が続きと流入する臨海部に対し、内陸部は、同様の場所があれば、古くからの住民が暮らす小規模木造密集住宅地もある、モザイク模様の都市である。木造密集住宅地の火災、いわゆるゼロメートル地帯の洪水など、防災上の課題を抱える都市でもある。しかし、東京都心部から約5kmの便利な場所に位置し、旧運河の豊かな水面と緑地の充実を図り、暮らしやすいまちとなる高いポテンシャルを持っている。主体的に課題を発見し、環境資源を取出し、持続可能なまちづくりにつながる案を構想する。



Project Site - Koto ward, Tokyo Metropolitan Area

第1回 10/04 (水) ガイダンス：テーマの説明、対象地の説明

第2回 10/11 (水) リサーチ：現地にて対象地の情報収集 (江東区 CIG 係よりレクチャー、対象地調査)

第3回 10/18 (水) エスキス1：提案するエリア・場所を選定、課題抽出

第4回 10/25 (水) エスキス2：提案する場所の課題解決につながるアイデア出し

第5回 11/01 (水) 中間発表：提案するエリア・場所の課題解決につながる具体的なデザイン提案

第6回 11/08 (水) エスキス3：提案のストーリーの表現方法を検討

第7回 11/15 (水) まとめ発表：提案が地域にどんな価値を生み出すか伝える

第8回 11/22 (水) 最終講評会

ゲストコメンテーター

須永 留美

特定非営利活動法人 江東区の水辺に親しむ会 理事長

みどりネット KOTO 副会長

UIFA JAPON (国際女性建築家会議) 広報担当

JUDI (学術団体 都市環境デザイン会議) 運営委員

佐藤留美様

特定非営利活動法人 NPO birth 事務局長

東京の緑を守る将来会議代表

# The Best Work - "Echujima Line Park" by Hinako Tagi

## コンセプト

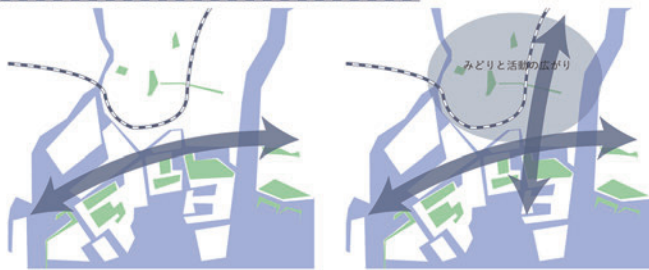

現在、江東区は緑被地や鉄道が東西へ伸びる傾向にある。  
越中島貨物線の南北方向に伸びているという特徴を活かし、内陸部のみどりや、それに伴う人々の活動を広げることができる。

## 南北のつながりから東西へ (ダイアグラム)

### 自転車 LRT の運行

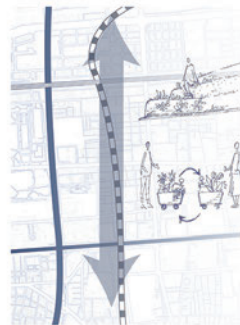

日に3往復以下という貨物線の運行状況から、線路を公共化して利用することが可能である。子供やボックス型の車を南北へ運ぶ LRT は、支線の役割を見る人々に印象づける。



### パブリックスペース

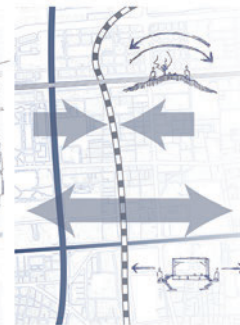

盛り土の高さを利用して、東西から人々が集うパブリックスペースや街を見渡す視点を確保することができる。分断された街を結び直す軸線の役割を持つ。



### レインガーデン (GI)



土が露出するという特徴から、レインガーデンを東西南北へ広める起点(起線)とする。

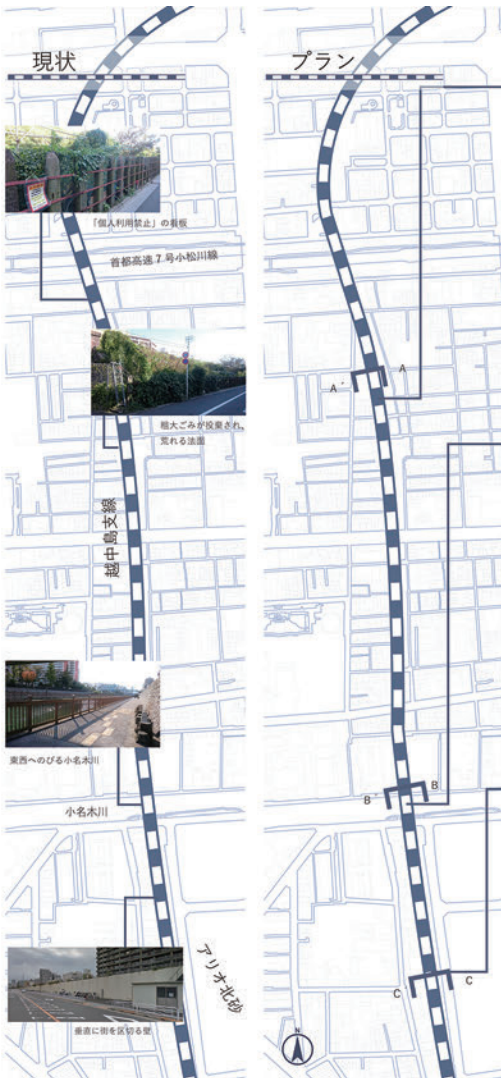

## 大島地区



法面を近隣住民に開放し、CG やクラインガルテンを整備する。長い線路は遠くまで視線を通し、仙台堀川公園とはまた違う雰囲気のある公園となる。線路沿いを歩けることで、近所のみで留まらない広いコミュニティの形成も期待できる。

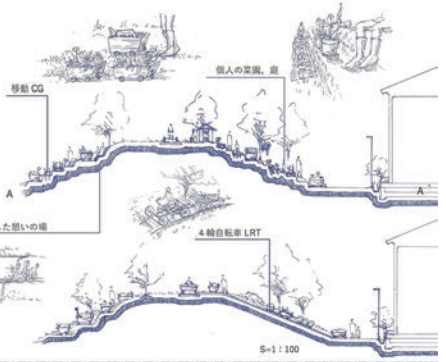

## 小名木川交差点

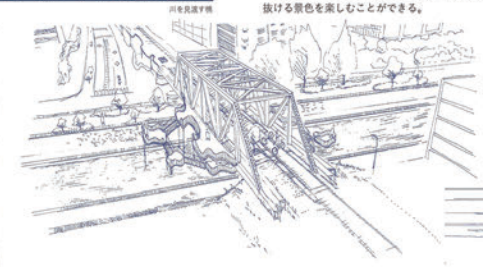

橋から川へ下りていくデッキでは、小名木川の中心に立ち、東西へとまっすぐに抜ける景色を楽しむことができる。

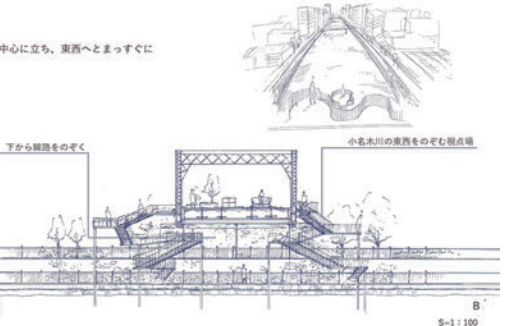

## アリオ北砂付近

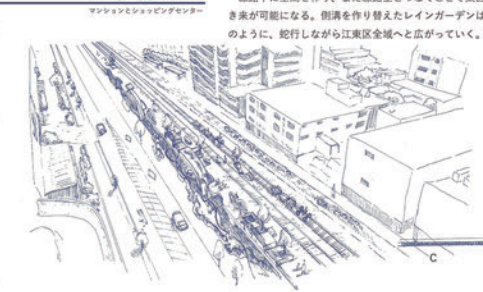

線路下に空間を作り、また線路上とつなぐことで東西南北、上下方への行き来が可能になる。倒壊を作り替えたレインガーデンは、起伏の上を流れる水のように、蛇行しながら江東区全域へと広がっていく。

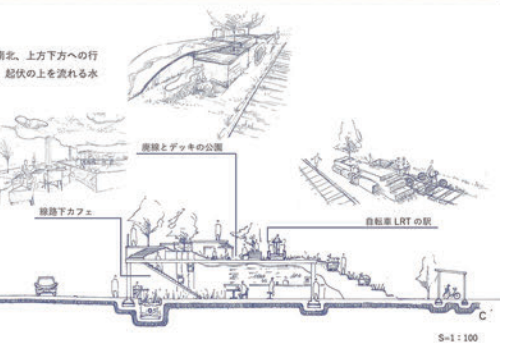

Masayuki Mukohyama  
TAKENAKA Corporation

**Review:** This proposal has good valance of attractive idea by solving regional issues. The existing freight rail with only three times round trip between Koiwa and Echujima is her target site since existing North-South transportation system is weak. She proposed attractive bicycle Light Rail Transit system and install terraced farm lands, community gardens, and cafeteria. She successfully proposes landscape design idea that could change the existing single function infrastructure into multifunctional place enhancing urban values. (Masayuki Mukohyamai / Katsunori Furuya)

## Landscape Architecture Studio 3-2 "Design & Build work for Olive Commune"

Instructors: Yoshiki Mishima, Isami Kinoshita

This studio includes design & build work on site and the target site is Nakano district, Ichihara city in Chiba. Students are expected to learn comprehensive landscape design process through the design & build work. As the result of the studio work, the four group could propose design ideas and built the work collaborating with local community. The theme was "ancient tomb", "Old footpath", "Bench", and "Kitchen". This studio was highly evaluated not only by hearing ideas but also as great opportunity to connect local community again. Even after the WS, students continue to have activities for the community.

### 地域をつくるデザイン&ビルド

本実習では千葉県市原市中野地区にある「オリーブコミュニン」という約1haのオリーブ園を舞台として、この場所を地域づくりの拠点として活用していくためのデザインを考え、また、そのデザインを現地で実現することを通じて、包括的なデザインプロセスを学ぶことを主なねらいとした。実習の成果として、4つのグループがそれぞれ「古墳」、「古道」、「ベンチ」、「キッチン」をテーマとしてデザインの提案を行い、地域住民と協働してデザインを現地にて実現し、最後には地域住民に対してプレゼンテーションを行った。この取り組みに対して、地域住民からは「アイデアを聞くだけでなく実際に一緒につくれたことがとても刺激になった。住民同士がつながるきっかけにもなった。」などの声が聞かれるなど大好評であった。WS後も学生たちはこのコミュニティのための活動を自発的に継続している。

### Schedule

- 01 Site visit
- 02 Concept making
- 03 Mockup making
- 04 Mid-term Presentation at Chiba University
- 05 Design & Build work #1
- 06 Design & Build work #2
- 07 Design & Build work #3
- 08 Final Presentation on the site, Nakano district

- 第1週：(12月3日) 現地視察  
 第2週： コンセプト立案  
 第3週： 提案の試作  
 第4週： 中間講評会@千葉大学  
 第5週： 実施製作1  
 第6週： 実施製作2  
 第7週： 実施製作3  
 2月4日： 現地発表会@中野



Project Site - Nakano, Ichihara City, Chiba

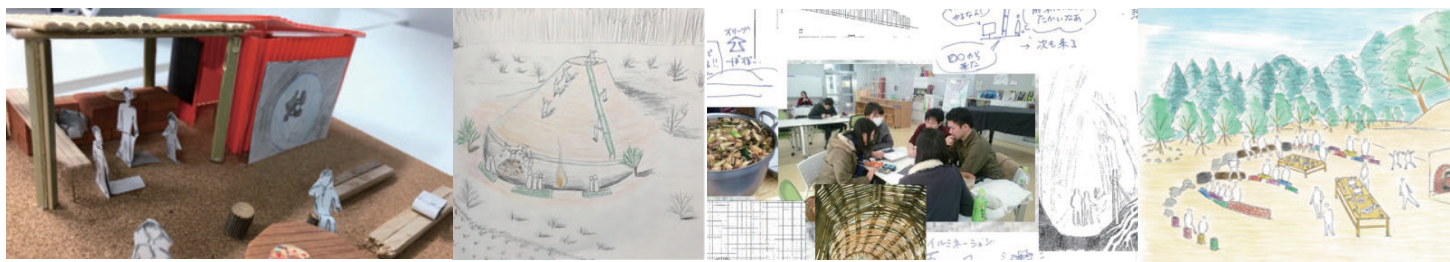

Design Development

Every built work is evaluated as the best



"Olive Kitchen" by Group 1

**Review:**  
Group-1: This group built a community kitchen for everyone could cook by yourself with using cheap materials like a bamboo and concrete blocks. Although the build work seems to be difficult, they made maximum effort and high quality open kitchen was realized.



"Olive Bench" by Group 2

**Review:**  
Group-2: This group built several types of benches using wood and stone materials so as to create people's community place with careful study of the appropriate circle shape. They revised their ideas many times to fit it in the condition.



"Olive Kofun" by Group 3

**Review:**  
This group focused on many existing historical heritages like an old tomb and old Kannon for horses. By reclaiming the existing old tomb, they tried to create multi-purpose place for kids and green exercising. At the fining timing, they invited local people and kids to collaborate to create places to be loved.



**Before**



**After**

"Tonosama michi" by Group 4

**Review:**  
This group tried to revitalize an old footpath called "TONOSAMA MICHII" with collaborative workshop involving local community. In order to visualize the regional resources, they installed sign facilities as if those are fit well in the exiting landscape.



**Yoshiki Mishima**  
FOLK Landscape Architecture

**Member:**

- Group-1: 赤石大輔、木内伸太郎、佐藤裕菜、鈴木悠平、東島健哉
- Group-2: 大村智生、外内裕真、保島和司、山名優紀
- Group-3: 石川小夜子、笹原洋平、向吉真央、高地達史、管原瑞紀、山下息吹
- Group-4: 田木日奈子、清水剛志、千葉敦、清野志保子、竹内慶



## Landscape Architecture Studio 3-2

### "Re-design of an existing urban park in Ginza"

Instructors: Taku Suzuki, Junhua Zhang TA: Minami Musha

In recent year there has been an active movement to re-consider park management, and in response to that there has been a focus to design a park that features its originality and unique identity. In this class we focused on re-designing an urban park in Ginza that survives the hustle and bustle of today's energetic urban setting. The main goal of this class was to re-consider the role of public space that is surrounded by a landmarked department store, a historic primary school, and elevated highway in a busy urban city where many visitors including foreign tourists come and go daily. There were a lot of design proposal that represented the historical and cultural aspect as well as the complexity and diversity of Ginza.

### 銀座・数寄屋橋公園のリ・デザイン

近年、パークマネジメントという言葉とともに公園を管理、運営することの重要性が見直されているが、設計においてその公園のあるべき姿、特色を十分に引き出してあげることも重要である。本実習においては数寄屋橋公園を対象に、銀座の玄関口にふさわしく、都市の喧騒にも負けない公園の在り方を考えてみたい。東急プラザなど商業店舗に囲われ、泰明小学校と敷地の一部を共有し、外国人観光客など様々な人々が行き来するこの場所で、パブリックスペースの在り方を再考してみることが実習のねらいである。銀座の文化と歴史を尊重しながら多様で複雑な都市の姿を分析し、銀座の“いま”にふさわしい提案がいくつもあった。



Historical Map and Pictures



設計対象地：中央区立 数寄屋橋公園  
Sukiyabashi Park, Chuo City, Tokyo

### Schedule

#### 【第1回】

「現地調査と興味対象の発見」

設計テーマの探求と設定について

Site analysis and interest discovery

#### 【第2回】

「設計テーマ別に計画地の歴史、背景の分析と設計で取り組みたいことをプレゼン」

設計のテーマ、コンセプトの設定について

Finding design theme and concept

#### 【第3回】

「設計テーマ、コンセプトの確定とデザインスタディ」

設計のヒント、デザインの進め方について

Exploring design process

#### 【第4回】

「デザインスタディ」

論理的なデザイン思考の展開について

Developing logical design

#### 【第5回】

「成果品作成作業」

最終アウトプットの表現方法とプレゼン方法について

Discussing the final design idea and presentation method

#### 【第6回】

「アウトプットの途中経過発表（70%程度完成）」

講評会プレゼンテーションに向けての準備について

Progress report and preparation for final presentation

#### 【第7回】

「最終講評会」

Final presentation of design proposal

The Best Work - "Art Camp " by Marina Nakamura



Taku Suzuki  
NIKKEN SEKKEI

**Review:** This design proposal has succeeded to highlight Ginza's two main attractions, art and retail, while retaining the primary function of a park. It attempts to make the park more open to the community by featuring art work on the site as well as transforming the space under the elevated structure to an art gallery and studio spaces. The main feature of this proposal is a runway stretching from the art gallery towards the adjacent department store. This event space can hold various activities including fashion shows and it has a potential to enhance and enliven the art culture in Ginza. (Taku Suzuki / Junhua Zhang)

## Landscape Architecture Project Studio-A TOKYO CANYON "Creation of the new water-front historical park"

Instructors: Noriko Akita, Takeshi Kinoshita, and Ryosuke Shimoda

This studio aims to create a new water-front park at the site which has the history as a sacred place of learning. This site is the place where the first university was established by Shogunate Government of Edo in 1790. A hospital and a University are there at present, but we assume those will move to the suburb. Compiling a trace of the history in there, connect to the waterside space and design the new park that everyone can enjoy.

### Schedule

4/12 Guidance day

4/19-26 PHASE-1: Feeling and Finding a landscape  
"Suggestion of the zoning and framework of the spatial structure at the site"

5/10-17 PHASE-2: Understanding geographic conditions  
"Recognition of Topography of the site and surrounding area"

5-24-31 PHASE-3: Design proposal of "New water-front historical Park" – make your own title

5/31 Final Review

### Submittal

Drawings (1/500), Diagrams, Detail drawings at least 2),  
Image sketches or perspective drawing, models(Optional)

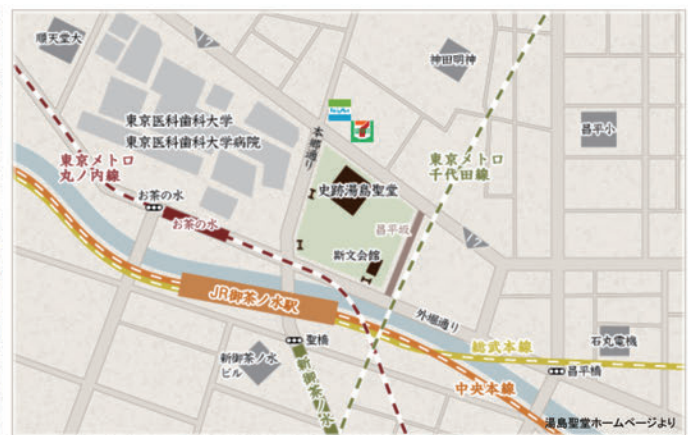

map draw in Edo era  
[江戸切絵図]本郷湯島絵図,  
景山致哉[ほか編],  
江戸 尾張屋清七  
嘉永2-文久2[1849-1862] 28舗





北斎 新橋浮世神明田神御祭の表/図 painted by Katsushika Hokusai



Research Phase



Final Review

### New style bright station platform

Water Green Communication

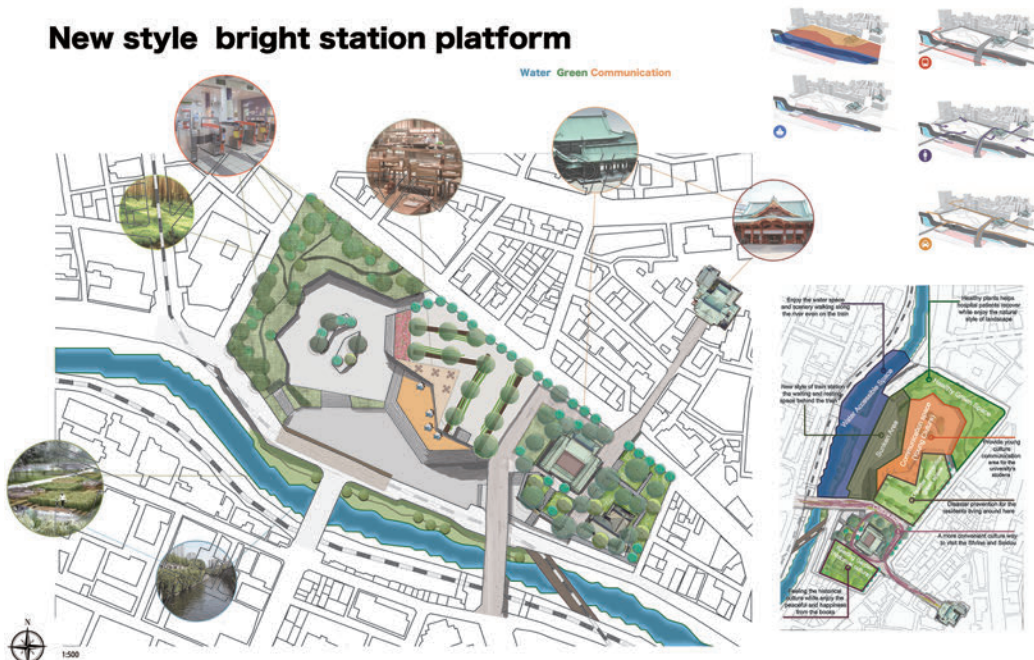

### Group 4 Work

Xu Haoran, Su Di, Nan Hong, and Makoto Yoshio

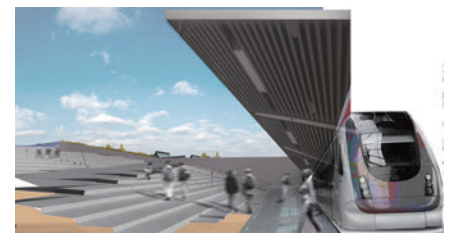

## Landscape Architecture Project Studio-B TOKYO CANYON "Historical urban valley as green/blue infrastructure"

Instructors: Takeshi Kinoshita, Noriko Akita, and Ryosuke Shimoda

The purpose of this studio is to propose the landscape design to regenerate Sendaibori/Kanda River as contemporary multi-functional urban infrastructure. This site is a part of old moat of Edo Castle and is also functioning as an artificial river. We will study possible green and blue infrastructure not only to enhance historic character, but also to wisely use the ecological potentials of this site.

### Schedule

6/7 Guidance day

Explanation of studio work and target site

Site visit

Grouping

6/14-21 Concept work

- The possibilities to have green/blue infrastructure installed in this target area will be studied through preparing site analysis map
- Decision of the target site: concept making and rough design will be delivered by sketches and diagram

6/28-7/5 Schematic design

- The functions and structure in and around the target site will be studied through functional diagram (1/1500-1000)
- Master Plan (1/500-200) of the target site will be prepared

7/12-19 Design development

- Detailed design (1/20-10) of green/blue infrastructure and perspective sketch
- Preparing final presentation: PPT or panels, scale model(optional)

7/26 Final Review

### Landscape Architecture Project Studio 2017 TOKYO CANYON Final Presentation on the 31st of May





Field study at Todoroki Canyon and Futakotamagawa Rise

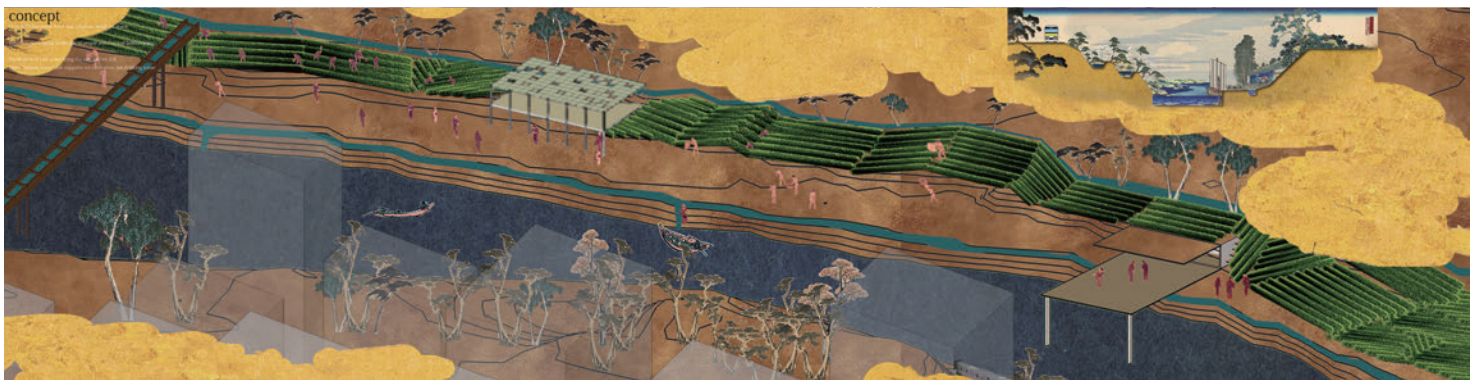

Group-A work

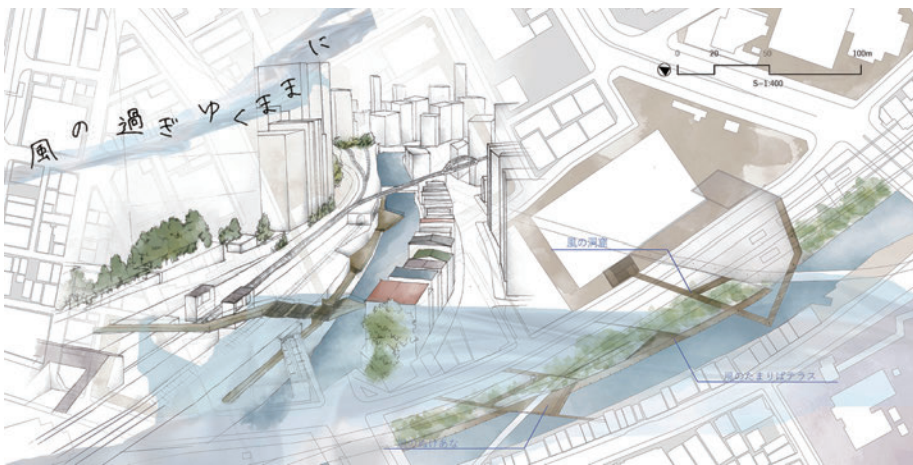

Group-E work

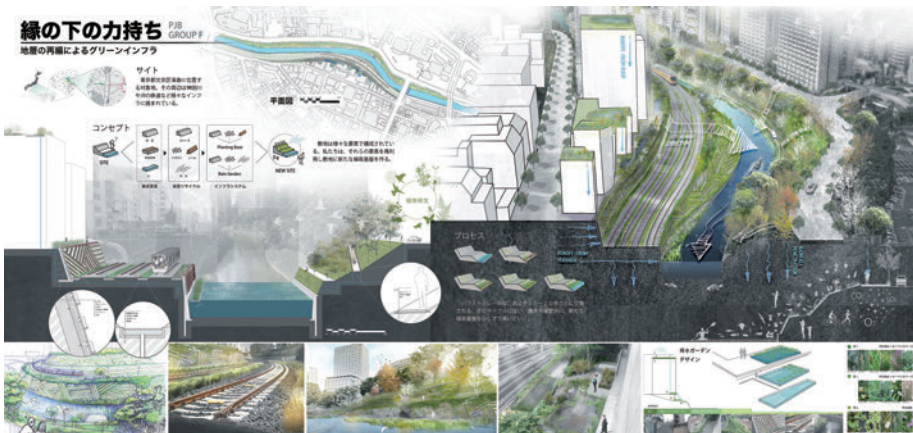

Group-F work

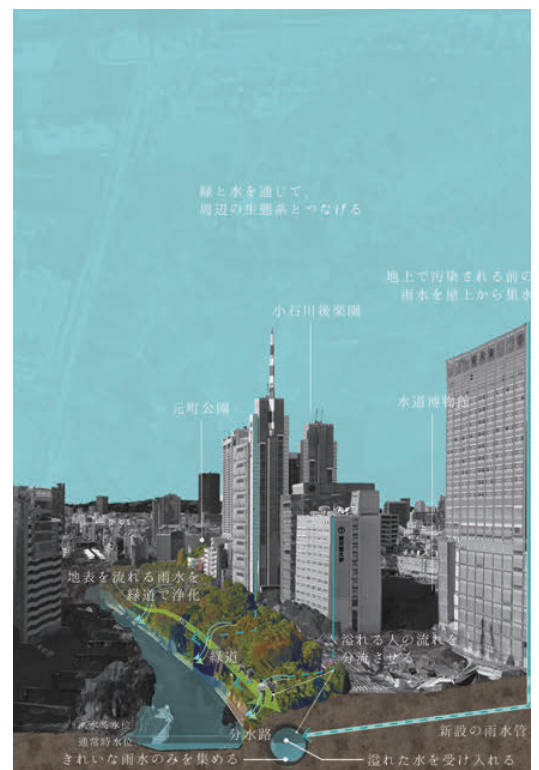

Group-B work

# Landscape Architecture Project Studio-C

## "Edible & Craftable Biophilic Landscape Design"

Instructors: Isami Kinoshita, Ryosuke Shimoda TA: Mariia Ermilova, Mistunari Terada

"Biophilia" as an idea describes how people have innate love for, attachment to, and even need for nature. It also expresses the notion that, as a design imperative, cities are more livable when they have more nature, and that people are happier and healthier when they have more contact with nature, from wild parks away from buzzing traffic all the way to street trees and flowers in tree pits"

(c) The Nature Of Cities.

Currently we use different design methods to promote communication between residents of different generations and increase community well-being:  
 participatory design - involving children and other community members in planning and reflection;  
 biophilic design - edible, craftable, landscape and activities; animals and plants in common space, which stimulate dialog between residents and with the environment and also provide a habitat for wildlife.

We would like students of summer school to create design objects, considering biophilic landscape design. The design objects preferable should stimulate residents interest in natural environment and promote communication between them. Among others, we would be happy if they can contribute to local biodiversity, providing habitat for animals and can be used for ecological education purposes.



1	岩瀬自治会集会所周辺の庭 Iwase Jichikaikan, garden	[Design&Built]
2	鈴木さん家の庭 Suzuki House Garden	[Design]
	1と2をつなぐ緑のネットワーク化。 岩瀬の公園をうまく活用したい。	[Design]
3	岩瀬みんなの庭 Iwase community garden (Minnanoniwa)	[Design&Built]

### Schedule

#### 8/24-27 Design Phase

What	Where	Who	Prepare
<b>Goal:</b> ① Understand the background of Community and Project ② Easy sketch of Design idea ・自治会紹介：神田さん ・対象地紹介：マリア、田中さん、鈴木さん	Chiba University, Iwase Community Center	・Kanda ・Suzuki ・Tanaka	・ Notification to Community
<b>Goal:</b> 調査&デザイン	Iwase Community Center	・Kanda ・Suzuki ・Tanaka	・ Notification to Community ・ Information collection hearing sheet ・ translation to japanese ・ posters print
デザイン&地域の調査	Iwase Community Center Matsudo central park	・Kanda ・Suzuki ・Tanaka	・ Bring table, tent, chairs ・ Information collection hearing sheet, posters
デザイン&地域の調査	Matsudo central park Free	・Kanda ・Suzuki ・Tanaka	・ Bring table, tent, chairs ・ Information collection hearing sheet, posters

#### 8/28-30 Build Phase

What	Where	Who	Prepare
<b>Goal:</b> ① Understand the background of Community and Project ② Easy sketch of Design idea ・自治会紹介：神田さん ・対象地紹介：マリア、田中さん、鈴木さん	Chiba University, Iwase Community Center	・Kanda ・Suzuki ・Tanaka	・ Notification to Community
<b>Goal:</b> 調査&デザイン	Iwase Community Center	・Kanda ・Suzuki ・Tanaka	・ Notification to Community ・ Information collection hearing sheet ・ translation to japanese ・ posters print
デザイン&地域の調査	Iwase Community Center Matsudo central park	・Kanda ・Suzuki ・Tanaka	・ Bring table, tent, chairs ・ Information collection hearing sheet, posters
デザイン&地域の調査	Matsudo central park Free	・Kanda ・Suzuki ・Tanaka	・ Bring table, tent, chairs ・ Information collection hearing sheet, posters





The vegetation mat "NONOHANA MAT" provided by Nakada Seeds & Nursery



Site-1 Iwase Community Center "Japanese style rain garden"



Site-3 Iwase Community Garden and Insect hotel



Site-2 Suzuki san's garden

**協力・協賛**

Iwase Neighborhood Community Association  
(岩瀬自治会)

Iwase Community Center, Ms. Suzuki in Iwase, and Ms. Tanaka in Iwase Community Garden  
(岩瀬自治会館、岩瀬地区鈴木様、岩瀬みんなの庭 (田中様))

Representative Director of Nakada Seeds and Nursery, Shigeji Nakada  
(仲田 茂司様 仲田種苗園)

**助成**

Chiba University Educational GP  
(千葉大学教育 GP)



**Bern University of Applied Science (Switzerland)**

Alexander Schneider  
Arif Sadek  
Chiara Camilla Aurelia Braun  
Simon Lüthi



**The University of Sheffield (U.K.)**

Namlia Mahabba  
Ahmad Rahmani



**Hunan University (China)**

Yan Yang  
Huajie Yun



**Chiba University (Japan)**

蘇 荻  
徐 浩然  
劉 成玉  
Liyong Lu  
曹 翊  
Motoko Yoshio  
胡 博文



## Landscape Architecture Project Studio-D

### "Horse as a force to revitalize a region in Fukushima"

Instructors: Ryosuke Shimoda, Isami Kinoshita TA: Yasuhiro Mita

#### 人馬一体による地域再生

Ishikawa Town in Fukushima prefecture (福島県石川町) is an area with very low radiation called "cool spot" which is almost same as Tokyo, even though located in 60km far from Fukushima-1 Nuclear Power Station. Many areas not only Ishikawa Town in Fukushima has social problem such as dwindling birth rate and an aging population accelerated by a nuclear accident caused The Great East Japan Earthquake in 2011.

In other to solve the regional issues and revitalize the town, Ishikawa town has been developing their master plan called "Sakuradani Trail" (石川桜谷トレイル) which will go through the town area and surrounding hilly and mountain area. In this workshop 2015, we had a field survey for finding environmental and cultural treasures in Ishikawa town, then discussed concrete ideas and work with officers from the town office and local entities concerned. In 2016, we have a design & Build activity with local people to create Kids park and a rain garden in a former Ishikawa Elementary school.

This year in 2017, we will focus on an old 400m horse track (養駒運動場) in Nakada region(中田郷) located in the Eastern part of Ishikawa town, where originally the local people grew a horse as a military use until 1940's. The horse track used be connected to the highest hill called NIHONBUNA (二本ブナ) and surrounding pasture area. We will think about new idea to reuse the area as a part of regional trail for a landscape tourism in this area.

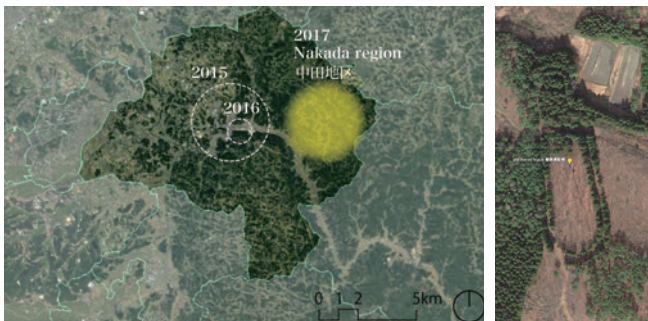

old horse track  
(Google Earth)

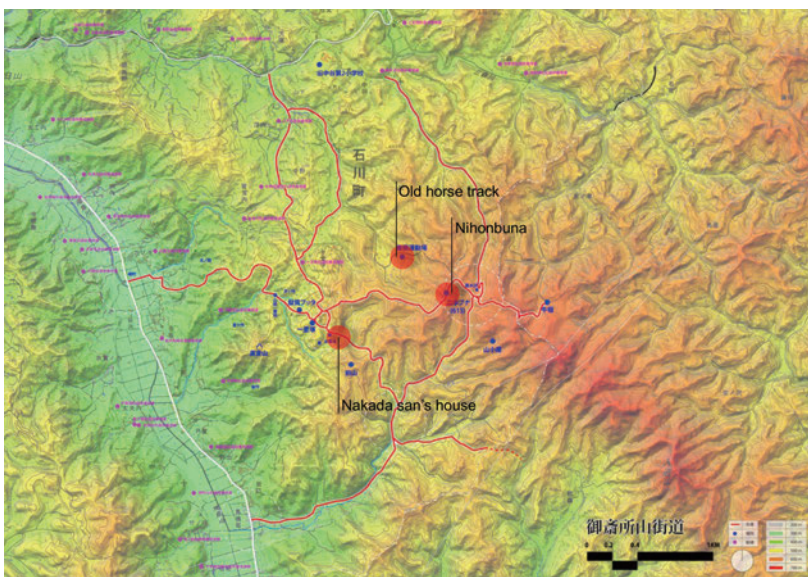

Ishikawa Town and the target area in 2017(MAP: Yasuhiro Mita)

#### Schedule

11/3(FRI) : Landscape Excursion in Nakada Region

8:30 Departure from Matsudo  
9:22 DEPT. Ueno station - Tohoku Shinkansen  
10:40 ARR. Shinshirakawa station  
10:50 Meet at Shinshirakawa Station entrance gate  
11:00 BUS to Ishikawa town  
12:30 LUNCH  
13:30 NAKADA san's house 仲田茂様宅  
13:40-16:00 Landscape excursion at the old horse track and surrounding area  
養駒運動場及び周辺の現地調査  
16:30 Arrive at IZUTSUYA (Onsen Ryokan)

11/4(SAT) : Tree cutting, Design & Build work

8 : 30 DEPT. IZUTSUYA  
9 : 00 Arrive at the old horse track 養駒運動場到着  
9 : 00-16:00 Workshop with Nakada Forestry Cooperative  
1. tree trimming of shrubs on the track  
2. tree trimming of surrounding trees of main big cherry, Prunus jamasakura  
3. woodwork using by the trimmed trees  
4. making a campfire base structure by using a remain of an old charcoal oven on site

11/6(SUN) : Exchange event and Trekking on "Nakada Trail"

8 : 30 DEPT. IZUTSUYA  
9 : 00-12:00 Arrive at the old horse track and workshop  
1. finishing a campfire base structure by using a remain of an old charcoal oven on site  
2. Welcoming a local patriarch over 80 year's old, and sharing their history in this area  
NOTE: those elder people have an experience for growing a horse at the track and potluck party at the site during the 80 years.

12 : 00-13:00 Lunch at Mr Nakada house  
13:30-15:30 Trekking on "Nakada trail" (3km existing footpath)

Old Nakatani elementary school - Ishashimizu (spring water)  
- Old horse track - Nihonbuna (the highest hill, old pasture site)



Tree cutting activity collaborated by the forest cooperative and students group



1



2

### Conceptual Plan

A & B group - AM: tree trimming of shrubs on the track (トラックの雑木の伐採) PM: woodwork using by the trimmed trees (伐採木を使った工作)  
 C group - AM: digging the old charcoal oven (大竹炭窯跡の発掘) PM: artwork using by the wood to dig on the old charcoal oven (大竹炭窯跡より利用した木を使った工作)

Objective is to reveal the hidden old horse track and charcoal oven by clearing the shrubs, making woodworks from the trimmed trees and a campfire base structure.

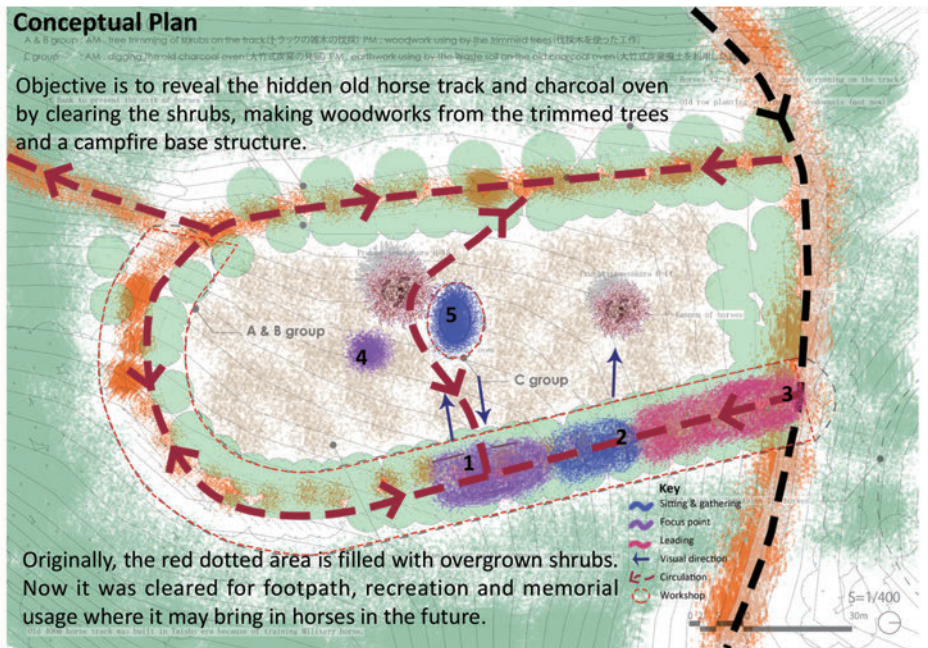

Originally, the red dotted area is filled with overgrown shrubs. Now it was cleared for footpath, recreation and memorial usage where it may bring in horses in the future.



3

### Concept - Group B

Our group would like to use horse's hoof as the design language to represent the idea of bringing back the memory of horses. Starting from the beginning of the track, coloured horse's hoof landart (3) are marked on the sloped which draws users attention to the next woodwork - the bench (2). The footprint was composted with red, yellow and green leaves bounded by branches and pebbles. Visitors can sit on the bench which is made from branches to view the Sakura tree. Then, there is a viewing point where visitors are forced to



4



5

focus on the charcoal oven and horse model between the fences (1).

Group A made a horse model (4) named Hanako to respond to history and act as a focal point. It is made by leaves and sticks from the trimmed trees. Group C made a campfire base structure (5) from the remain of an old charcoal oven where they dig and decorate it.

Group A-C Horse shoe shape landscape artifacts (drawing: Hiu Lam)



### 協力・協賛

NPO 法人ふくしま風景塾  
 JC いわき石川青年会議所  
 中田造林組合  
 仲田 茂 様 ご夫妻  
 助成

Fukushima Prefecture Land Readjustment Association(FLA)(福島県区画整理協会)  
 Chiba University Educational GP (千葉大学教育 GP)

# 05 STUDIO-E CAPE Landscape Design

Bachelor's

Master's

## Landscape Architecture Project Studio-E "Socio-ecological landscapes in the development of Kashiwanoha Smart City"

Instructors : Ryosuke Shimoda and Ayako Nagase (Chiba U.), Puay Yok Tan and Yun Hye Hwang (NUS), Hailong Liu (Tsinghua U.)

### CAPE - Campus Asia Plant Environmental innovation

Currently we are proceeding international design program called "Campus Asia Plant Environmental innovation" which has been running collaborating with several prominent universities in China, Korea, and Chiba University. There are two section regarding the project, Service design part and Landscape Design Part. Each university will have some obligation to give a financial aid, like a scholarship and providing accommodation for students who come to your country.

### Objective of Design Workshop

Using an existing site, the workshop asks students to explore the potential of an existing shopping mall 'LALA PORT' for greening the city. The site is chosen as it is located near the Kashiwanoha station and playing a role as a public space especially for families, but one which seems to be underutilized, or its potential not fully optimized. In developing the design, the broad considerations are the appreciation of the relevance of greenery in the development of Smart City of the future through benefits greenery can bring, how greenery can be made more "ecological", and how even a simple existing space through deliberate design, can potentially deliver more than conventional designs. The students will choose from one site in LALA PORT and show the design as a part of Green Infrastructure.

### Schedule

2.24 SAT	DAY01 Kashiwanoha
10:00 - 12:00	Introduction (Tan, Shimoda, Nagase, LIU)
12:00 - 13:00	Lunch
13:00 - 15:00	Observation of Kashiwanoha campus
15:00 - 16:30	Groupwork 01 (Tan, LIU, Shimoda, Nagase)
2.25 SUN	DAY02 Tokyo
<b>Site visit (Tan)</b>	
2.26 MON	DAY03 Kashiwanoha
09:30 - 12:00	Plant factory tour and lecture (Lu Na)
12:00 - 13:00	Lunch
13:00 - 14:00	Kashiwanoha landscape Tour (Mitani)
14:30 - 16:00	Tour in Kashiwanoha Campus Town (Mitsui real estate)
16:00 - 17:30	Groupwork 02 (Tan, Shimoda, Nagase)
2.27 TUE	DAY04 Nishichiba
09:30 - 12:00	Groupwork 03 (Tan, LIU, Shimoda)
12:00 - 13:00	Lunch
13:00 - 15:00	Special Lecture 01 Shimoda, LIU, Dr.Yamada
15:00 - 17:30	Groupwork 04/ LIU returning
2.28 WED	DAY05 Nishichiba
09:30 - 12:00	Groupwork 05 (Tan, Hwang, Shimoda)
12:00 - 13:00	Lunch
13:00 - 14:00	Special Lecture 02 Tan
14:00 - 17:30	Groupwork 06
3.1 THU	DAY06 Nishichiba
09:30 - 12:00	Groupwork 07 (Tan, Hwang, Shimoda, Nagase)
12:00 - 13:00	Lunch
13:00 - 14:00	Special Lecture 03 Green roof tour
14:00 - 17:30	Groupwork 08 (Tan, Hwang, Shimoda, Nagase)
3.2 FRI	DAY07 Nishichiba
10:00 - 13:00	Final Presentation (Tan, Nagase, Dr.Yamada, Shimoda, Marco Santangelo (Mitani))
13:00 - 15:00	Farewell Party
3.3 SAT	DAY08 Tokyo
<b>Site visit (Tan, Nagase)</b>	

### CAPE 2018 Design Workshop

Landscape Design Part

Socio-ecological landscapes in the development of Kashiwanoha Smart City



### Chosen sites & themes

**GA: Hydro Scapes**  
Retooling Detention Pond into Multifunctional Waterpark  
Detention Pond

**GB: Forging Identity Through Memories**  
Transposing history into the socio-ecological landscape of Kashiwanoha Smart City  
Gate Square Street

**GC: Park "ING"**  
Adaptive Design for Parking Lots According to City Development  
Parking Lot

**GD: Biophilic Kashiwanoha**  
Living close to Nature, bringing Biodiversity closer to People  
Parking Lot



# HYDROSCAPES MULTIFUNCTIONAL NEIGHBOURHOOD WATER PARK

**GROUP A**

National University of Singapore  
 Amanda Chandra  
 Dai Junwei  
 Tsinghua University  
 Pei Yu  
 Chiba University  
 Tomomi Seki

**BACKGROUND**

EDUCATION/MART CITY MASTER PLAN  
 OPEN SPACE  
 LAND USE ZONING  
 TRANSPORTATION

**DEFINITION**

ARRANGE MULTIFUNCTIONAL OPEN SPACES WITH ACTIVITIES

**ANALYZE**

POND/LANDSCAPE/SURROUNDING CONDITIONS  
 POND/LIFE CIRCLE/SURGRADE/FACTURE  
 A SYSTEM OF GREEN AND PONDS  
 DETAILED DESIGN  
 TAKE POND AS AN EXAMPLE

**ANALYZE**

Condition  
 greenland  
 potential points  
 subway/bus roots  
 pedestrianing

**STRATEGY**

**CONCEPT**

**MASTER PLAN**

sky bridge  
 green corridor  
 subway  
 street trees  
 green roof

**CHARACTERS**

Group-A work

# FORGING IDENTITY THROUGH MEMORIES

Transposing History into the Socio-Ecological Landscape of Kashiwanoha

GROUP B PAGE 1

SHI OU (OU), ASHLEY SUN (NUS), HIRAKO TADU (OU), PENG QINYI (THU)

URBAN AGRICULTURE  
 NATURALISED STREAM  
 RAIN GARDEN  
 GRASSY SLOPE FOR PLAY  
 AMPHITHEATRE SPACE  
 RAIN GARDEN  
 NOMADIC CAFES

PROPOSED PLAN 1:1000

ISSUE- REGIONAL SCALE  
 PROPOSAL  
 DISCONNECTED NEIGHBORHOODS  
 POTENTIALS FOR CONNECTION  
 DISCONNECTED ALLEYS  
 ISLANDS LOOP WITH ALLEYS  
 DISCONNECTED ADJACENT PLACES  
 FRAGMENTED NEIGHBORHOODS

REGIONAL STRUCTURE

ISSUE- SITE SCALE  
 PROPOSAL  
 DISCONNECTED HISTORICAL  
 IMPORTANT SITE HISTORICAL NEW  
 BUILT-UP

HISTORICAL ELEMENTS

STEP 4  
 STEP 5  
 STEP 6  
 STEP 7. PROPOSAL

A-A SECTION  
 B-B SECTION

Group-B work

# Park "ING"

Connecting Functioning Greening  
 Smart city Smart parking lot

Chiba University----- Hu Bowen  
 NUS----- Bai Zhuhui Yan Ran  
 Tsing Hua University----- Zhang Shujie

Parking Lot Space Analysis  
 Existing Parking Space Analysis  
 Planning Change Strategies

Habitat for target species

*Cyanospiza cyana*  
 Azure-winged magpies  
 City bird of Kisawa

*Zelkova serrata*  
 Keyaki  
 Built a nest at a height of 1-13m above the ground.

*Diopros kaki L.*  
 Japanese persimmon trees  
 (foraging)  
 Feed in the upper layer of a tree and mainly on the ground. Ground with foliage and insects are important.

2018 - Now  
 2020 - Tokyo Olympic

Group-C work

# BIOPHILIC KASHIWANOHA

BRING PEOPLE AND BIODIVERSITY TOGETHER

Design Group: XU LU (OU), ZHOU ZHANGMENG (THU), RONG YU (THU)

Ecological Connection of Kashiwanoha  
 Distribution of National park in Japan  
 Site Location

Proposed ecological corridor of Kashiwanoha

Analysis of Landscape Transformation  
 1970  
 1980  
 2004  
 2018

Vegetation succession  
 Social Connection

Shrubs  
 Arbors

Group-D work

